

THE LATE MINOAN IIIA:2 SETTLEMENT

STRATIGRAPHY AND CATALOGUES

BUILDING 1

From what could be seen in the preceding chapter it seemed obvious that Building 1 (*Fig. 2, Pl. 8*) was constructed during the very beginning of the LM IIIB:1 period, in that little LM IIIB:1 pottery was noted in many of the constructions, i.e. walls and earliest floors. Almost everywhere within the excavated area we also found deposits, bits of floors and walls which were sealed below the LM IIIB:1 building and above the LM II/IIIA:1 deposits and pits. This continuous phenomenon at the site is best studied within the Courtyard and the Rubbish Area Southeast and to a certain extent in the architecture of the period.

The Courtyard was constructed in the LM IIIA:1 period and was, with alternations and additions, used until the LM IIIC period, and we have been able to isolate one phase of the Courtyard belonging to the LM IIIA:2 period. Likewise the Rubbish Area Southeast, which was dominated by a large pit in the LM IIIA:1 period, revealed several large pits of the LM IIIA:2 period – sealed between LM IIIA:1 and LM IIIB:1.

Below LM IIIB:1 Building 1 we found fragments of walls and floors which stratigraphically could only be placed within the LM IIIA:2 period. The scanty architectural evidence seems to show that in the LM IIIA:2 period there existed a building which to some extent reused the walls of the LM I houses (also to some extent reused in LM II/IIIA:1) but new walls were also constructed. The architectural fragments of this period are far too scanty to permit any certain reconstructions of the architecture, but there seems to have existed a large room or space, Space A-D, measuring *c.* 9 × 6 metre below what was in the LM IIIB:1 period Rooms A-D. East of this space there appears to have been three or perhaps four rooms or spaces, that to a large extent reused the walls of the LM I building. These spaces were constructed over several LM IIIA:1 pits.

Whatever existed of this LM IIIA:2 building was, with the exception of 15-Wall 2 and 15-Wall 3, demolished when LM IIIB:1 Building 1 was constructed and we believe that the large amount of LM IIIA:(2) pottery and other finds discovered north of Building 1 (both in the LM IIIA:2 and in the LM IIIB:1 layers) may represent the contents of the demolished LM IIIA:2 building.

SPACE A-D (*Figs. 7a-b, 10, 15, 21, 75, Pls. 23c:1-4, 75-77b*)

Below LM IIIB:1 Building 1, Rooms A-D and above LM I, House IV was identified a sizable Space with a floor at levels 9.10/9.04. The floor, found while excavating in Rooms A, C and D, went below the walls of these LM IIIB:1 rooms, and the fragment of a wall, 17-Wall 7 (stratified below the LM IIIB:1 floors of Room A), constituted the southwestern wall of this space. It also seems certain that 15-Wall 2 belonged to this space, since there was a door with a threshold to connect it to the neighbouring Space E. This door was blocked up in LM IIIB:1, cf. above p. 68. The northwestern wall remains slightly enigmatic, while it should be noted that the LM I wall of House IV, 14-Wall 7, was still preserved to a height of 0.35 above the LM IIIA:2 floor. The southeastern wall is 15-Wall 3. We are thus left with a sizeable space, which measures roughly 9 × 6 metres, *c.* 54 m².

Three floor fragments were found: the western, the central and the eastern. In the southern part of the central floor, i.e. below Room A two floor levels were noted, while in the remaining part only one floor was registered. We also found a thin layer everywhere below the floors – probably a floor-packing, while in the southern part of the central floor we also excavated a levelling deposit. In the floor around 508.5-509.5/703-704 the possible bedding for a hearth was noted, and within 513.8-515/700.5-701.5 a hard burnt area was noted.

The upper floor in the central southern part, 17-Floor 9/16/17 (*Figs. 7a-b, 10, 75, Pl. 75a-b*)

The floor was excavated over two years in 1980 (as 17-Floor 9) and 1984 (as 17-Floor 16/17) (*Pl. 75b*). It appears, with the exception of 17-Pit J, to have covered the whole floor area. The thickness of the floor was 0.05-10. It was excavated at levels 9.21/9.11 to 9.10/9.04. There was no description of floor-packing. In the western part close to the later shaft (cf. above p. 43) was a very ashy spot surrounded by red clay.

17-Floor 9 was hard packed reddish-brown clay with pieces of lime, small dots of orange burnt clay and pieces of char-

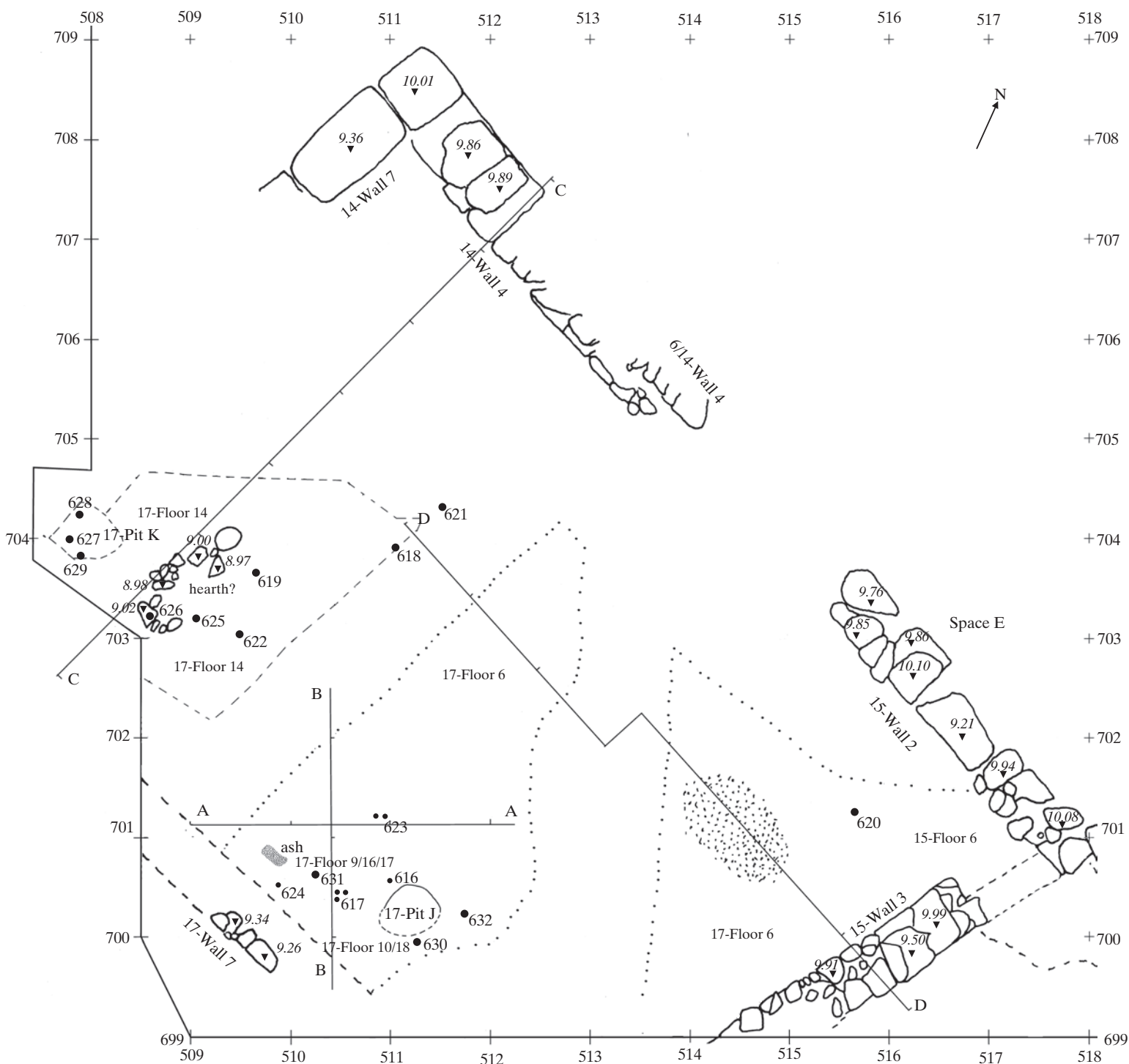

Fig. 75. LM IIIA:2 Space A-D, plan of floors and distribution of finds. Reduced 90% of original in 1:50.

coal. 17-Floor 16 was rather hard-packed, light brown with pebbles, while 17-Floor 17 was ashy in some parts, red clay, pebbles, some yellow clay. For the larger part of the floor, 17-Floor 6, see above p. 68).

The pottery appears to be mainly LM IIIA, and a few MM. 1.450 kg of pottery was collected: 3% decorated, 44% kept and 4.8% inventoried. Shapes counted (1984): 1 leg of tripod cooking pot.

POTTERY

80-P 1212, *Pl. 194a:4*

Cup, body frg. Clay: buff, hard, fine. Int. monochrome brown to black. Th. 0.003. LM IIIA:1/2.

80-P 1213, *Pl. 194a:5*

Goblet, small, foot frg. Clay: light brown. Plain ware. Foot Ø est. 0.062. LM IIIA:1/2.

84-P 2747, *Pl. 194a:1*

Cup, body frg. Clay: light brown with grey core. Ext. running spirals? and a body band. Th. 0.003-4. LM IIIA:2.

84-P 2748, *Pl. 194a:2*

Closed vessel, body frg. Clay: light brown. Ext. alternating arcs? Th. 0.008. LM IIIA:2.

84-P 3236, *Pl. 194a:3*

Closed vessel, body frg. Clay: light yellowish-brown. Ext. a body band. Th. 0.005-7. LM IIIA:2.

OBSIDIAN

84-OB 217, **Chip of core's reduction** [616]; 84-OB 221, **Debris or waste by-product of core reduction** [617]; 84-OB 222, **Blade** (damaged piece) [617]; 84-OB 223, **Bladelet** [617].

BONES

Very few bones from adult and young *Ovis*.

Comments: As usual very little finds were noted in the floors.

Floor deposit in western part (*Figs. 15, 75, Pls. 23c:1-4, 75c*)

In a similar stratigraphic position (below the LM IIIB:1 floors in Room C) we discovered, within 508-511.2/702.3-704.8, a small floor deposit on 17-Floor 14. The floor was not identified north of 704.8 and it is an open question whether a wall existed closer to the floor or whether LM I 14-Wall 4 of House IV was the outer wall. The latter is probably the case since this wall was, in all likelihood, visible during the LM IIIA:2 period.

Excavating in the floor around 509/703.5 we came upon a half-circle of stones with much burnt material on top, and it is just possible that we have here the remains of a hearth. At any rate, much ash was noted on top of the floor in this area. The deposit was only a thin layer in-between the floors and 17-Floor 14 was noted to be "All over ... covered with ash". The soil is described as light pinkish-brown.

LM IIIA and few earlier pieces were noted. 4.980 kg of pottery were collected: 11% decorated, 79% kept and 2.5% inventoried. Shapes counted: 1 undecorated kylix and 1 conical cup.

POTTERY

84-P 2756, *Pl. 194a:12*

Closed vessel, body frg. Clay: reddish-brown. Close to a neck. Ext. a neck band, a band around handle section? and a spiral. Th. 0.006. LM IIIA:2.

84-P 2757, *Pl. 194a:13*

Mug, rim frg. Clay: buff, hard, fine. Straight rim, flat on top, three low ridges below rim ext. (int. broken off). Ext. RB. Th. 0.008-9. Myc IMP. FS 225. LH IIIA:2.

84-P 2758, *Pl. 194a:7*

Cup, body frg. Clay: red. Int. monochrome red. Ext. two body bands pres. Th. 0.004. LM IIIA:1/2.

84-P 2759, *Pls. 134, 194a:9*

Mug?, rim frg. Clay: LW. Slightly marked rim, a low ridge on upper body. Int. RB. Ext. RB, a band below and hatched triangles? Rim Ø est. 0.13. Th. 0.003. Misfired. LM IIIA:2.

84-P 2760, *Pl. 194a:10*

Alabastron, globular, body/handle frg. Clay: LW. Part of a horiz. roll handle. Ext. bars on top of handle, a band around attachment and a body band. Handle 0.011 × 0.012. Th. 0.002-3. LM IIIA:2.

84-P 2761, outside j.

84-P 3131, *Pl. 194a:6*

Cup, base frg. Clay: reddish-brown. Flat base. Int. monochrome. Ext. base band. Th. 0.004. LM IIIA:1/2.

84-P 3132, *Pl. 194a:8*

Cup, base frg. Clay: LW. Flat base. Int. a band around base. Ext. base band. Base Ø est. 0.04. Th. 0.005. LM IIIA:1/2.

84-P 3133, *Pl. 194a:11*

Closed vessel, base frg. Clay: reddish-brown. Flat base. Ext. base band. Base Ø est. 0.10-11. Th. 0.011. LM IIIA:1/2.

Outside joins

84-P 2761 to 74-P 0119/01-P 0153/0164, LM IIIA, Vol. V.

71-P 0305, Rubbish Area North, dump, p. 244.

72-P 0100, Vol. V.

73-P 0148, *GSE III*, 44.

74-P 0171, Space E, levelling deposit, p. 207.

77-P 0315, *GSE I*, 108.

77-P 0494, *GSE II*, 101.

77-P 0506, *GSE III*, 101.

82-P 1780, LM IIIB:1, Courtyard, 1st phase, 19-Pit T, p. 166.

84-P 1220, LM IIIB:1, Rubbish Area Southeast, 20-Pit M, p. 128.

84-P 1392, Vol. V.

84-P 1950, LM IIIB:1 Courtyard 1st phase, p. 168.

87-P 0524, LM IIIB:1, Space G, 23-Floor 9/10, p. 89.

SMALL FINDS

84-B 010, *Pls. 229, 255b:1, 511.06/703.80/9.05* [618]

Disc-shaped object of bone, completely pres., only smaller pieces missing. Thin, one side slightly curved, other side flat. Hole intentionally pierced in middle. On flattened side are traces of an incised pattern, seemingly of network-like shape. It consists of alternatively one and two parallel incised lines. Bead or button? Ø 0.025. Th. 0.006.

84-MISC 094, *Pl. 255b:2* (see below, Shells) [619]

BONES

Single bone from adult *Bos*.

SHELLS

1 *Glycymeris* – water-worn, distal frgs. 1 *Spondylus* – upper, umbonal frg., fresh (84-MISC 094).

Comments: One shell and one bead of bone was found on the floor. The joining sherds, which all belong to a large LM IIIA:1 jar, are all over the excavated area and must be due to general human activity – a chance scatter since some sherds are attributed to earlier contexts.

The lower floor (*Figs. 7a-b, 10, 15, 21, 75, Pls. 75d-76, 77a*)

17-Floor 10/18. The lower floor in the central southern part of the room is described as a pebble floor, and in its western part has lots of ash and red clay. Apparently there was also a burnt part in the southeastern area. This floor was only 0.05 thick and might have had a levelling deposit (see below). It was excavated at levels 9.10/9.04 to 9.05/9.00. It was the original floor belonging to this space. The floor consisted of hard-packed, reddish-brown soil with bits of charcoal in patches with *kouskouras* and yellowish-green clay on top. It contained LM IIIA, and a few earlier pieces. 1.215 kg of pottery was collected: 5% decorated, 76% kept and 5.7% inventoried. Shapes counted: 2 conical cups.

17-Floor 14 and hearth(?). The floor in the western part appears to be not equally well-preserved in all places – especially not in its western parts, but especially over the supposed hearth area it was very severely burnt and with ashes mostly east of that. We suppose that the area with the stones below the

very burnt area belongs constructionally with the floor, though it is not absolutely certain. (For the supposed floor-packing/levelling deposit, see below 17-Pit K and deposit north.) The hearth(?) (*Pl. 77a*) is described as: "Beneath the ash was a hearth consisting of c. 13 stones (0.10-25) lying in a semicircle. Some of the stones were burnt black. Ash together with red clay surround the stones". LM IIIA and a few earlier pieces was noted. 2.210 kg of pottery were collected: 2% decorated, 76% kept and 5.1% inventoried. Shapes were not counted.

17-Floor 6 and 15-Floor 6. Considering that the original floor of this period was probably reused in the following phase, only very little from the southeastern part of the space can actually be considered as belonging to this phase: i.e. taking out the lower floor in Room D (see above, pp. 68-69). It should be noted that this floor in an area around 514.5/701 was severely burnt with much ash and charcoal bits. The floor itself consisted of a dark brown clay mixed with reddish-brown compact soil. It contained a lot of stones, small pieces of charcoal and lime. A small repair to the floor (15-Floor 6, *Pl. 75d*) was reddish-greyish-brown with lots of charcoal and stones. LM IIIA pottery with few earlier pieces. 2.010 kg of pottery were collected: 5% decorated, 90% kept and 0.7% inventoried. Shapes counted (1984): 4 conical cups and 1 footed cup.

POTTERY

77-P 0821 (+73-P 0341; 80-P 1022; 80-P 1037), *Pls. 141, 194b:1*

Cup, rim/body frags. Clay: light red, hard, fine. Ledge rim. Int. monochrome shiny reddish-brown paint. Ext. RB, a row of dots, a wavy band, tricurved arcs with dots and multiple arcs in-between, two thin body bands pres. Rim Ø est. 0.15. Th. 0.003. KNO. LM IIIA:1/2.

80-P 1238, *Pl. 194b:3*

Cup, body frg. Clay: LW. Ext. a tricurved arcs and two body bands pres. Th. 0.003. Burnt. LM IIIA:2.

80-P 1239, *Pls. 134, 194b:2*

Mug, rim frg. Clay: LW. A low mid-ridge. Straight rim. Ext. RB, elaborate triangles and a broad mid-body band. Rim Ø est. 0.092. Th. 0.003-4. LM IIIA:2.

80-P 1240, *Pl. 194b:6*

Closed vessel, body frg. Clay: light brown. Ext. sponge pattern. Th. 0.004-5. LM IIIA:1.

80-P 1241, *Pl. 194b:5*

Closed vessel, body frg. Clay: light brown. Ext. broad and thin curved bands. Th. 0.005-6. LM IIIA:2.

84-P 2752, *Pl. 194c:1*

Cup, rim frg. Clay: light yellowish-brown. Straight rim with a low ridge below the lip. Int. RB. Ext. RB, concentric semicircles and multiple arcs. Th. 0.004. LM IIIA:2.

84-P 2753, *Pl. 194c:2*

Cup, body frg. Clay: light brown. Int. sponge pattern. Ext. zigzag and filled triangles. Th. 0.004. LM IIIA:1/2.

84-P 2754, *Pls. 137, 194c:4*

Krater, rim frg. Clay: light reddish. Buff slip. Plain ware. High, flaring rim. Rim Ø est. 0.30. Th. 0.005-6. LM IIIA:2.

84-P 2755, *Pl. 194c:7*

Vat, spout frg. Clay: red with grey core. Coarse fabric. Rim flat on top, sloping from H 0.057 to 0.038, flat base. Th. 0.017. Burnt. LM IIIA:1/2.

84-P 2804, *Pl. 194c:3*

Mug, rim frg. Clay: red. Straight rim. Int. RB. Ext. RB and hatched ovals. Rim Ø est. 0.12. Th. 0.003. LM IIIA:2.

84-P 2805, *Pl. 194c:6*

Closed vessel, body frg. Clay: LW. Ext. a filled semicircle? and two body bands. Th. 0.005-8. Burnt. LM IIIA:2.

84-P 2806, *Pl. 194c:5*

Cup, body frg. Clay: cream. Int. monochrome. Ext. an elaborate lozenge framed by wavy bands. Th. 0.003. LM IIIA:2.

84-P 3154, *Pl. 194b:4*

Cup, body frg. close to a rim. Clay: LW. Int. RB. Ext. RB and concentric semicircles? Th. 0.003-4. LM IIIA:2.

Intrusive sherd

84-P 2751, *Pl. 194c:8*

Footed cup, one-handed, lower body/stem frg. Clay: LW. Plain ware. Stem Ø 0.024. Late type. LM IIIB:1.

Outside joins

77-P 0821 to 80-P 1022, LM IIIB:1, Room D, constructions, p. 70.

73-P 0341, LM IIIB:1, Room E, extension, p. 106.

80-P 1037, LM IIIB:1, Room A, constructions and related, p. 47.

SMALL FINDS

77-M 072, *Pl. 255d*, 515.64/701.30/8.96 [620]

Bronze, frg., rod. Very corroded, traces of charcoal. L 0.018. Th. 0.004.

84-TC 042, *Pls. 229, 255c:2*, 511.58/704.22/9.06 [621]

KS whorl, completely pres., but slightly chipped. Clay: hard, fine-grained, light reddish-yellow (LW). Slip: buff. H 0.015. Ø 0.025. Ø of SH 0.0035. Weight 0.015.

84-S 045, *Pl. 255c:6* [622]

Polisher, type 3, rounded, completely pres. Greenish-grey stone with lighter particles. Upper part fits well in the grip of a palm; surface is also smoothed here. Two facets from polishing. Percussion marks on two opposite sides. Ø 0.070. Weight 0.296.

OBSIDIAN

80-OB 298, **Blade** [623]; 80-OB 299, **Chip of core's reduction** [623]; 84-OB 224, **Bladelet** [624].

BONES

Few bones representing adult *Ovis* and adult and young *Sus*.

SHELLS

1 *Patella* – L 0.0235. 1 *Murex* – distal and columella, L 0.057+, large.

Comments: The floor in the western part 17-Floor 14, was lying on top of an LM IIIA:2 deposit covering an LM II pit, confirming that this is a construction of the LM IIIA:2 period. This floor seems, in its northern part, to have been mixed with the Venetian foundation pit to W1-018. The coordinates given for the KS-whorl (84-TC 042) would place it in the foundation pit of the Venetian wall and it cannot be ruled out that the footed cup (84-P 2751) may well have derived from the same pit. Worthy of note in connection with Space A-D in the LM IIIA:2 period are the many traces of fire and ash noted on the floor, and it is tempting to suggest that it may have been an open or half-open space used for industrial activities.

Levelling deposit (*Fig. 75*)

Below 17-Floor 10/18, Figs. 7a, 10

In the central southern part there was a relatively thin layer below 17-Floor 10/18 which may have been a levelling deposit, at least as described in the southern part, with the characteristic of many stones in a loose soil. In the southern part it was only a few cms thick while it was heavier in the northern part. It was excavated at levels 9.09 down to 8.83. In southern part it was a dark reddish-brown, rather soft soil with many stones and pieces of reddish burnt clay. In the northern part the soil was light brown, fairly fine. The pottery was mainly

LM IIIA with some LM I included. 0.747 kg of pottery was collected: 2% decorated, 61% kept and 5.6% inventoried. Shapes were not counted.

17-Pit K and deposit north (Figs. 15, 75)

The possible floor-packing/levelling deposit below 17-Floor 14 was only recognized in its northwestern part. The deposit was excavated at levels from 9.02 down to 8.89 and it contained a fairly hard-packed, reddish-brown soil with pieces of mud-bricks. 17-Pit K, dug into the levelling deposit, contained light brown, soft soil with stones and many sherds. In all baskets LM IIIA and a few earlier pieces were noted. 4.940 kg of pottery were collected: 4% decorated, 75% kept and 1.1% inventoried. Shapes counted: 1 footed cup and 2 conical cups.

Below 15-Floor 6 and 17-Floor 6 (Fig. 21)

The only possible levelling deposit from below the eastern floor was excavated at levels from 9.12 down to 8.90. It is described as red and grey with hard dots of red clay, ash and lots of charcoal. The mention of the many stones seems to indicate a carefully constructed floor with a solid bedding. Only LM IIIA, LM I and a few pieces of MM were noted. 2.660 kg of pottery were collected: 6% decorated, 89% kept and 2.1% inventoried. No shapes to be counted.

POTTERY

80-P 1007, *Pl. 194d:3*

Cup, shallow, rim frg. Clay: pinkish-white (LW). Plain ware. Slightly marked rim. Th. 0.003. LM IIIA:1/2.

82-P 1681, *Pl. 194d:7*

Tripod cooking pot, leg frg. Clay: red. Coarse fabric. Leg oval in section \emptyset 0.028 \times 0.036. Burnt. LM IIIA:1/2.

82-P 1682, *Pl. 194d:5*

Closed vessel?, handle frg. Clay: light red. Yellow slip, reddish-brown paint. Handle roll in section Handle 0.008 \times 0.010. LM IIIA:1/2.

82-P 1683, *Pl. 194d:6*

Cup, body frg. Clay: light brown. Int. monochrome. Ext. a thin diagonal band. Th. 0.003. LM IIIA:1/2.

84-P 2766, *Pl. 194d:8*

Closed vessel, body frg. Clay: red turning brown int. Yellow slip and red paint. Ext. monochrome with reserved curved bands. Th. 0.007-10. LM IIIA:1/2.

84-P 2768, *Pls. 129, 194d:9*

Cup, rim/body frg. Clay: LW. Straight rim. Int. RB. Ext. RB, concentric semicircles and iris, two body bands. Rim \emptyset est. 0.13. Th. 0.003. LM IIIA:2.

84-P 3155, *Pl. 194d:4*

Cup, body frg. Clay: reddish-brown. Ext. shells? and a body band. Th. 0.004-5. LM IIIA:2.

84-P 3158, *Pl. 194d:1*

Closed vessel, base frg. Clay: brown. Slightly splaying base. Ext. broad base band, two vertical bands above. Base \emptyset est. 0.07. Th. 0.010-12. LM IIIA:1.

84-P 3201, *Pl. 194d:2*

Cup, rim frg. Clay: brown. Ledge rim. Int. RB. Ext. RB and alternating arcs? Th. 0.003. LM IIIA:1/2.

MM

84-P 2767, **Open vessel**.

SMALL FINDS

84-TC 043, *Pls. 232, 255c:3, 508.62/703.21/8.96* [625]

Loom weight/bobbin, type 5, completely pres., only slightly chipped. Clay: fine-grained, reddish. Slip: buff. Surface finely smoothed. H 0.050. \emptyset 0.040. \emptyset at waist 0.035. Weight 0.081.

84-TC 046 (Mus.no. Π 1565), *Pls. 231, 255c:1 508.62/703.21/8.96* [626]

Nodus or **Stopper** of conical shape. Completely pres. except for tiny fracture. Clay: brown to black, very hard-fired, finely gritted. Polished surface. Faint fingerprints. At bottom and part of one side the nodule seems to have been pressed against an object. At each end of the fracture along the edge are two tiny grooves, perhaps from strings. \emptyset 0.025 \times 0.022. H 0.014. Type of nodule uncertain: badly executed nodulus or badly executed clay stopper of the non-sealing type? In the base one almost complete impression of a lentoid of soft stone. Largest \emptyset (vertical to the axis of the animal's body) c. 0.0149. Surface fairly well preserved. Motif: Above a base line, toothed at the lower side, a running quadruped (bull?) in left profile with head turned back. Above the animal's back a branch. Undefinable elements in front of the animal's head near the edge of the motif. Fairly rough engraving. Publ.: *CMS V Suppl. 1A*, no. 146. LM IIIA?

84-AR 015, *Pl. 255e* [627]

Mud-brick, frg. without surface, few bigger inclusions and some sherds. Extremely hard burnt. Mpd 0.067. Th. 0.043.

84-S 053, *Pl. 255c:5* [628]

Polisher, type 2, completely pres. Light greenish-grey stone. Of an unusually even and rounded, almost ovoid shape. Two natural concentric bands in darker colour. \emptyset 0.085. Weight 0.312.

84-S 077, *Pls. 228, 255c:4* [629]

Stone vase, rim/body frg. Bird's nest bowl? Greyish-black, hard limestone with grey patches. High-shouldered form; chipped. Large in size? H 0.048. W 0.064. Th. 0.042. MM I? Survival. Warren 1969, type 3.

BONES

Few bones from adult *Sus* and *Bos*.

Comments: The loom weight/bobbin is by context the earliest known from Crete. Its find position may perhaps be connected to the possible hearth which recalls the find circumstances of ten loom weight/bobbins discovered in the 2005 excavations at the GSE (Tzedakis, Vlasaki & Hallager forthcoming, see further below p. 383). The nodulus or stopper is interesting in that it may be of LM IIIA date, one of the very few that can be dated that late. In these deposits we note a very low percentage of decorated pottery. Otherwise there are too few sherds to be of real statistical value.

Levelling mixed with LM IB (Figs. 7a, 75, Pl. 77b)

Underlying a smaller area in the central, very southern part, where the space had been disturbed partly by the wall foundation pit of W1-021 (cf. *GSE I*, 130-131) was the LM I destruction level. Apparently this was partly disturbed since a few LM III sherds turned up in this deposit. The majority of both pottery and finds belong to the LM IB destruction level. Especially the lower part of the excavated area had all the characteristics of the destruction level. It was excavated at levels from 9.06/9.02 down to 8.50. Dark reddish-brown, soft, burnt soil with many pieces of charcoal and pieces of burnt clay. Further down many fallen stones were noted. The pottery was mainly LM I with a few pieces of LM III (A). 1.175 kg of pottery was collected: 22% decorated, 67% kept and 9.5% inventoried. Shapes were not counted.

POTTERY

80-P 1005, *Pl. 194e:1*

Cup, deep, rim frg. Clay: light brown. Plain ware. Everted rim. Rim \emptyset est. 0.15. Th. 0.003. LM IIIA:1/2.

80-P 1006, *Pl. 194e:2*

Goblet, small, lower body frg. Clay: light brown. Plain ware. Th. 0.005-6. LM IIIA:1/2.

80-P 1026, *Pl. 194e:3*

Goblet, small, rim frg. Clay: light creamish-brown. Plain ware. Beg. of a vertical, strap handle from rim. Everted rim. Th. 0.004-5. LM IIIA:1/2.

80-P 1027, *Pl. 194e:4*

Conical cup, rim frg. Clay: light creamish-brown. Rim \emptyset est. 0.12. Th. 0.003. LM IIIA:1/2.

LM I

80-P 1003, **Cup**; 80-P 1004, **Open vessel**; 80-P 1025, **Cup**; 80-P 1028, **Cup**.

SMALL FINDS

80-AR 018Aa-k, *Pl. 255f* [630]

Mud-brick, 11 frgs. All of a dark red colour with pebbles and sherds included. a-f) Six frgs. of unshaped mud-brick; largest frg: L 0.10. W 0.105. Th. 0.101. g-k) Five frgs. with surface preserved. g is pres. in its full width and still has clay lining adhered. In these fragments impressions of leaves from wine and beans, and also some seeds of figs and probably also the impression from an almond were found. L 0.10. W 0.16. Th. 0.069-26 (Th. of clay lining 0.009). Biggest piece of remaining frgs.: Mpd 0.135. Th. 0.077. LM I?

80-AR 018Ba-b, *Pl. 256a* [630]

Clay lining, two frgs. One very large piece with surface pres., porous with much straw, light. Mpd. 0.12. Th. 0.115.

80-AR 018Ca-g, *Pl. 256b* [630]

Wattle and daub, seven frgs. a) Solid clay, imprints from three pieces of wood, two beams with a rectangular cut piece in-between. L 0.081. W 0.067. Th. 0.045. b) Triangular piece with two surfaces in a c. 30° angle-wedge between two pieces of wood? L 0.058. W 0.093. Th. 0.024. c) Frg. with hard sandy surface and with imprint from beam – roof construction? L 0.076. W 0.035. Est. \emptyset of beam 0.09. d) Frg. with hard sandy surface and imprint from two thin beams – roof construction? L 0.051. W 0.068. Th. 0.058. Est. \emptyset of beams 0.05 and 0.03. e) Frg. with imprints from roughly cut wood set at an angle of c. 70°. L 0.112. W 0.083. Th. 0.069. f) Frg. with very uneven surface(?) and possible imprints of two roughly cut wooden pieces on reverse. L 0.083. W 0.10. Th. 0.055. g) Frg. with small piece of fine surface and impression from large, roughly cut wooden piece, also imprints from stones. L 0.124. W 0.122. Th. 0.102. LM I?

80-S 040, *Pl. 255a:1* [631]

Percussion stone, type 2, completely pres. Black stone with white grits. Percussion marks on either short side. \emptyset 0.090. Weight 0.500.

80-S 048, *Pl. 255a:2* [632]

Percussion stone, type 2, completely pres. Greenish-grey stone with white veins. Percussion marks on either short side. \emptyset 0.075. Weight 0.184.

Comments: Important to note is that the pottery in this deposit appears to be of LM IIIA:1 date although the plain ware cannot be closer dated within LM IIIA. If indeed the pottery is LM IIIA:1 it further strengthens the stratigraphical position of the LM IIIA:2 room. The mud-brick was characteristic of the LM I House and the percussion stones fit well into the assemblage of what turned out to be characteristic of the fallen debris of the LM I House IV.

SPACES E-H (*Fig. 2, Pl. 8*)

The general idea about this building, as indicated by the very scantily preserved evidence, is that the southeastern facade of LM I House I, 13-Wall 7 and 12-Wall 7, was reused in its full length up to 529/706.5. Upon the double wall between LM I

Houses I and IV a new wall (15-Wall 2) was constructed and in the eastern part of the building a new wall 12-Wall 15+12-Wall 8, was constructed upon an LM I partition wall. The northwestern wall of this building is unknown, but it seems likely that LM I walls, 6-Wall 5 + 7-Wall 4 + 9-Wall 13 were reused. 12-Wall 11 partly reused LM I walls, while 9-Wall 12 and 9-Wall 14 were new constructions of the LM IIIA:2 period, in that they were sealed below the LM IIIB:1 constructions with 9-Wall 12 built upon a pit of the LM IIIA:1 period while 9-Wall 14 was built both upon the LM IB destruction level and another LM IIIA:1 pit.

If these wall fragments are prolonged to meet the secure or conjectured walls mentioned above, this part of the LM IIIA:2 building consists of three spaces: Space E, Space F, and Space G. Whether Space H is an outside or an inside area remains uncertain.

Space E covers an area of c. 6.3×3.5 (22 m²) and two floors were noted in this space: in the eastern part a fragment, 7-Floor 4, found at level 9.41, while in the western part, 15-Floor 5, it was noted at 9.21, i.e. 0.20 lower. Could this be one floor sloping strongly towards the southwest? Both floors were found at a level below the top of 9-Wall 14 and also below the top levels of the conjectured walls of the space.

Space F covers an area of c. 5.0×1.5 (7.5 m²), and one floor fragment (12-Floor 5, west) was found within this space around 526/707 at level 9.96. Only in the very east corner of this space were the walls preserved to a height above this floor, while most of the walls including the partition wall to Space G was found at a level c. 0.40 below the floor.

Space G covers an area of c. 4×2 (8 m²). Here no floors were found while a few stones in the northeastern wall (12-Wall 15) would have existed at a higher level than a floor at 9.96 as found in Space F.

Space H has only a little bit of the northeastern wall (12-Wall 15) and a floor fragment (9-Floor 2) preserved. The floor was found at level 10.09-10.17.

It should be noted that both floor fragments in Spaces H and F were found outside the later LM IIIB:1 Building 1 and if our reconstruction of the LM IIIA:2 building is correct, it is obvious that quite a lot of work was involved in demolishing this building in connection with the construction of the LM IIIB:1 Building 1. In other words, this building was an entirely new construction, probably pre-planned and in principle totally ignoring the existence of the previous LM I walls, while the LM IIIA:2 Building 1 basically followed the outline of the LM I houses.

Too few architectural remains from the LM IIIA:2 Building 1 have been preserved to be sure of the above suggested reconstruction and we shall, in the following, only present the isolated parts as they were excavated.

SPACE E

15-Floor 5 (*Figs. 27B-B, 76, Pls. 24a:1, 77c-d, 78a*)

Space E almost certainly reused the LM I floor of House I, Room I as shown through the stratigraphy for the room

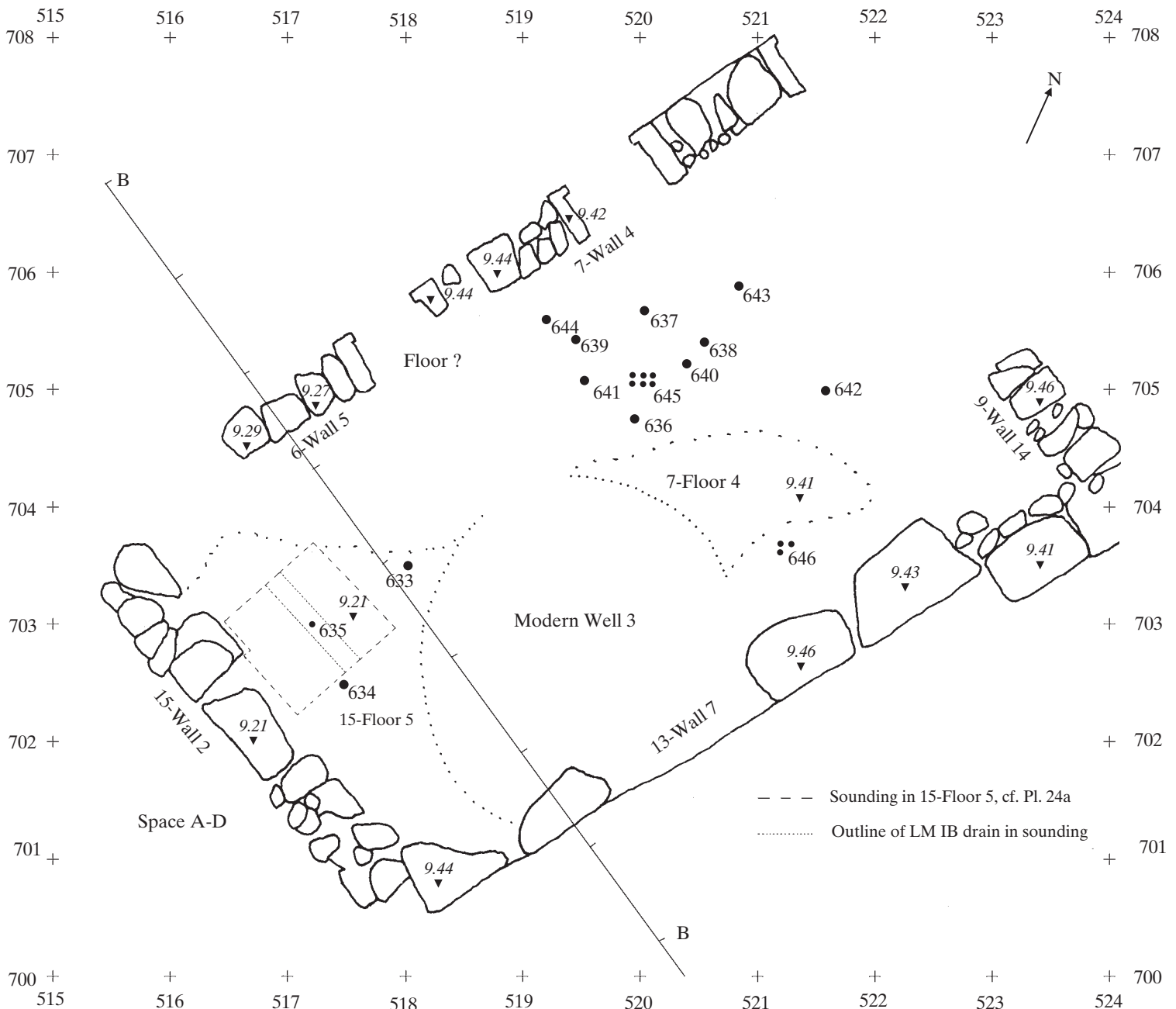

Fig. 76. LM IIIA:2 Space E, plan with distribution of finds.

noted during excavations in 1978 and 1980 in a small trial test through the floor (in area 516.4-517.6/702.25-703.5) up against 15-Wall 2. The floor, 15-Floor 5 (*Pl. 78a*), was found all the way up to the wall and in the southwestern part of the sounding an LM IIIA:1 pit was found going below the floor and the wall into Space A-D, while in the eastern part of the sounding pure LM I and earlier was found in and below the floor. Furthermore, the northeastern part of the LM I drain below the floor was mostly intact (*Pl. 24a*).

In the northwestern part of the room the floor was not preserved – it was the area where a large LM IIIA:1 pit had been cut down. The level of the LM IIIA:1 pit started approximately at the level of the floor. It is uncertain whether

or not the floor was preserved around c. 518/705 (below the LM IIIB:1 7-Wall 3), although *Pl. 77c*, may indicate that it had existed (at a slightly lower level than the threshold leading into LM I House, Room B, *Pl. 77d*). If correctly identified it indicates that the LM I door might still have been in use. Towards the southeast it seems that the LM I 13-Wall 7 was still in use – at least the corresponding floor outside the room (8-Floor 14) was at a level c. 0.15-20 below the existing part of the LM I wall, while the floor inside Space E was only a few cm below the preserved top of the wall. It seems obvious that it must have been in this phase that 15-Wall 2 was constructed partly on top of an LM IIIA:1 pit and the door with the threshold leading into Space A-D was functioning with

15-Floor 5 of Space E and the threshold was at the same level (compare the LM IIIB:1 Rooms C-D, above pp. 59, 69). Very little was excavated as a floor deposit in this room – where there were no signs of destruction by fire. Some earth belonging to this floor may have been excavated with constructions in the southern part of LM IIIB:1 Room E. Above the floor very hard brown earth was noted while below the LM IIIB:1 7-Wall 3 the soil was reddish with a few stones and lumps of charcoal. The floor is described as a reddish-brown clay floor with some small stones and a few pieces of charcoal. In the small deposits above the floor LM III pottery was noted. In the floor only LM I. 9.145 kg of pottery were collected: 7% decorated, 90% kept and 0.9% inventoried. Shapes counted (1974): 1 undecorated cup, 4 conical cups and 1 decorated cup.

POTTERY

Above floor:

74-P 0153 (+74-P 0012a), *Pls. 141, 194f:1*

Cup, rim frgs. Clay: light brown. Ledge rim, scar from a vertical strap handle. Int. monochrome. Ext. RB and network with loops. Rim Ø est. 0.14. Th. 0.004-5. KNO. LM IIIA:1/2.

74-P 0154, *Pl. 194f:2*

Cup, rim frg. Clay: light brown. Everted rim. Int. monochrome. Ext. RB, zigzag with loop framed by wavy bands. Th. 0.003. LM IIIA:2.

MM

74-P 0150, **Cup**; 74-P 0151, **Closed vessel?**; 74-P 0152, **Cup**.

In floor

LM I

78-P 0481, **Open vessel**.

Outside joins

74-P 0153 to 74-P 0012a, *GSE I*, 66, 67.

SMALL FINDS

74-M 004, *Pls. 229, 256c:2, c. 518/703.5/9.29* [633]

Bronze razor?, frgs., one piece in-between missing. Corroded. Slightly curved profile, one edge sharper than other one. Larger fragment: L 0.080. W 0.013. Th. 0.003. Smaller fragment: L 0.013. W 0.015. Th. 0.002.

77-TC 070, *Pls. 228, 256c:1, 517.66/702.31/9.25* [634]

Terracotta bead, completely pres. Clay: semisoft, very fine, light-brown. Biconical, centrally placed hole, grooves running vertically around bead. Ø 0.014. Th. 0.007. Ø of SH 0.004.

OBSIDIAN

77-OB 195, **Blade** [635].

BONES

Few bones representing young and adult caprid and *Sus*.

Comments: Both the razor and the bead were found *in situ* on the floor.

7-Floor 4 (*Fig. 76, Pl. 78b*)

The floor fragment was situated within the square 519.4-522.2/703.4-704.8 and was found at level 9.41. The floor was 0.03-0.14 thick and spots of ash were found upon it. The floor was found below the earliest LM IIIB:1 floor of Room E and

it partly covered a levelling deposit and a large pit 9/7-Pit A (cf. below). Of the pottery in the floor nothing was later than LM IIIA. 2.370 kg of pottery were collected: 9% decorated, 74% kept and 1.8% inventoried. Shapes counted (1974): 2 undecorated kylikes, 2 undecorated cups, 3 conical cups, 2 legs from tripod cooking pots and 1 miniature vase.

POTTERY

74-P 0145, *Pl. 194g:1*

Cup, rim frg. Clay: LW. Ledge rim. Int. RB. Ext. RB and a flower. Rim Ø est. 0.14. Th. 0.002-3. LM IIIA:1/2.

74-P 0146 (+77-P 0763/1021), *Pl. 194g:3*

Kylix, body frgs. Clay: LW. Ext. sea-anemones and a fish? Th. 0.003-5. LM IIIA:2.

74-P 0147, *Pl. 194g:2*

Cup, body frg. Clay: LW. Ext. lozenges with chevrons int. and a vertical band. Th. 0.003. LM IIIA:2.

Outside join

74-P 0146 to 77-P 0763/1021, South of Building 1, 13-Pits N/M/Q, p. 216.

Levelling deposit

The so-called levelling deposit of 7-Floor 4 was found partly below the floor, but also stretching outside the area of the floor. The soil in this deposit, excavated at levels 9.38 to 9.27/9.21 and in the northern area to 8.82, was a hard yellowish-brown red earth, occasionally with bits of charcoal. In the northern part, below this deposit, were pits and layers of the LM IIIA:1 period. The pottery was LM IIIA with some earlier pieces. 14.947 kg of pottery were collected: 9% decorated, 43% kept and 3.7% inventoried. Shapes counted (1974): 3 undecorated kylikes, 1 amphora, 1 decorated jug, 6 undecorated cups, 13 conical cups, 1 pithos rim, 5 legs from tripod cooking pots, 2 decorated cups and 1 decorated krater.

POTTERY

74-P 0064, *Pl. 194h:16*

Closed vessel, body frg. Clay: creamish-brown. Ext. network and two body bands (mostly worn off). Th. 0.007-9. LM IIIA:1/2.

74-P 0065, *Pls. 141, 194h:12*

Krater, rim frg. Clay: light reddish-brown fine. Everted rim. Int. monochrome. Ext. RB, a row of dots and below a band, elaborate lozenges. Rim Ø est. 0.18. Th. 0.005. KNO. LM IIIA:2.

74-P 0066 (+77-P 0197), *Pl. 194h:10*

Cup, rim/body frgs. Clay: LW. Everted rim. Int. RB. Ext. RB, a row of S's, a row of dots and a foliate band. Th. 0.003. LM IIIA:2.

74-P 0078, *Pl. 194h:11*

Closed vessel (large stirrup jar), body frg. Clay: dark brownish-grey. Cream paint on brownish-black surface. Ext. a body band. Th. 0.005-8. LM IIIA:1/2.

74-P 0106, *Pl. 194h:7*

Cup, rim/body frg. Clay: light brown. Everted rim, beg. of a vertical, strap handle. Int. monochrome. Ext. RB, zigzag, bands along edges of handle and vertical bands around handle section. Handle 0.008 × 0.023. Th. 0.003-5. LM IIIA:2.

74-P 0107 (+77-P 1804), *Pls. 131, 194h:14*

Kylix, rim/body frgs. Clay: red. Cream slip, reddish-brown paint. Everted (ledge) rim. Int. broad RB. Barred on top of rim. Ext. RB, concentric semicircles and three upper body bands. Rim Ø est. 0.18. Th. 0.004-6. LM IIIA:2.

74-P 0108 (+71-P 1406; 84-P 0809), *Pl. 194h:1*

Cup, rim/body frgs. Clay: LW. Everted rim. Int. RB and sponge pattern. Ext. RB and panelled pattern: horiz. rows of wavy bands framed by vertical bands. Three body bands. Rim Ø est. 0.15. Th. 0.003. LM IIIA:1/2.

74-P 0111, *Pl. 194h:3*

Cup, rim frg. Clay: LW. Everted rim. Int. RB. Ext. RB, a row of dots and a row of irises. Rim Ø est. 0.14. Th. 0.003-4. LM IIIA:2.

74-P 0171, outside j.

74-P 0197, *Pl. 194h:9*

Cup, body frg. Clay: yellowish-red. Scar from a vertical, strap handle. Ext. a shell and one broad body band. Th. 0.003. LM IIIA:2.

74-P 0198/0260, outside j.

74-P 0207, outside j.

74-P 0229, *Pls. 138, 194h:18*

Cup, miniature, full profile. Clay: red. H 0.045-0.048. Rim Ø 0.050 × 0.051. Base Ø 0.030. Th. 0.005. LM IIIA:1/2.

74-P 0234, *Pl. 194h:13*

Goblet, small, lower body/stem frg. Clay: light brown. Plain ware. Solid stem. Stem Ø 0.019. Th. 0.005-6. LM IIIA:1/2.

74-P 0235, *Pl. 194h:8*

Cup, rim frg. Clay: light brown. Everted rim (broken off). Int. RB. Ext. RB and elaborate lozenges. Th. 0.004-5. LM IIIA:2.

74-P 0259, *Pl. 194h:17*

Closed vessel, upper body frg. Clay: light red. Creamish-white slip and reddish-brown paint. Ext. hatched triangles? Th. 0.003-5. LM IIIA:2.

74-P 0261, *Pl. 194h:15*

Open vessel, base frg. Clay: light greyish-brown. Flat base with a moulding. Int. monochrome. Ext. base band and irregular paint underneath base. Base Ø est. 0.15. Th. 0.006-9. LM IIIA:2.

74-P 0262 (+73-P 0631), *Pl. 194h:5*

Cup, rim/body frgs. Clay: LW. Everted rim. Ext. RB, festoons with hatched triangles int. and three body bands. Rim Ø est. 0.14. Th. 0.003. LM IIIA:2.

74-P 0263 (+73-P 0625), *Pls. 129, 194h:4*

Cup, rim frgs. Clay: LW. Everted rim. Int. RB. Ext. RB, hatched parallel chevrons. Rim Ø est. 0.12. Th. 0.003. LM IIIA:2.

74-P 0264, *Pl. 194h:2*

Cup, body frg. Clay: LW. Ext. horiz. rows of wavy bands. Th. 0.003. LM IIIA:2.

74-P 0265, *Pls. 135, 194h:6*

Basket vase, small, rim frg. Clay: LW. Slightly flaring neck/rim, part of a basket handle on top of rim. Int. and ext. monochrome. A band on top of handle (area below handle on rim unpainted). Handle 0.005 × 0.007. Th. 0.002-4. LM IIIA:1/2.

74-P 0287, *Pl. 216e:9*

Pithos, rim frg. Sand-tempered fabric variant A. Red slip or paint on the ext. face. Very small rectangular rim, moderately beaked. Th. 0.013. Est. rim Ø 0.52. MpL 0.170. Joint from two pieces. Late MM-LM I/II.

74-P 0293, *Pl. 214d:5*

Pithos, body frg. Sand-tempered fabric variant A. Ext. slip sec. burnt. Thick rfb with crescent-shaped impressions?(2A). Th. 0.017. W of rfb 0.034. MpL 0.112. Rfb damaged. Sec. burnt on the ext. face. Late MM-LM I/II.

LM I

74-P 0067, **Open vessel**; 74-P 0068, **Open vessel**; 74-P 0070, **Closed vessel**; 74-P 0209, **Jug**; 74-P 0230, **Closed vessel**; 74-P 0236/0237, **Closed vessel**; 77-P 0977, **Cup**.

MM

74-P 0069, **Closed vessel**; 74-P 0072, **Open vessel**; 74-P 0073, **Open vessel**; 74-P 0074, **Cup**; 74-P 0075, **Cup**; 74-P 0076, **Cup**; 74-P 0077, **Cup**.

EM

74-P 0071, **Cup**.

Outside joins

74-P 0066 to 77-P 0197, *GSE I*, 132.

74-P 0107 to 77-P 1804, *GSE III*, 102.

74-P 0108 to 71-P 1406, LM IIIB:1, Room E, in lower floor, p. 101.

84-P 0809, LM IIIB:1, Rubbish Area Southeast, 20-Pit Q, p. 234.

74-P 0171 to 71-P 0305, Rubbish Area North, dump, p. 244.

72-P 0100, Vol. V.

73-P 0148, *GSE III*, 44.

74-P 0119/01-P 0153/0164, LM IIIA, Vol. V.

77-P 0315, *GSE I*, 108.

77-P 0494, *GSE II*, 101.

77-P 0506, *GSE III*, 101.

82-P 1780, LM IIIB:1, Courtyard, 1st phase, 19-Pit T, p. 166.

84-P 1220, LM IIIB:1, Rubbish Area Southeast, 20-Pit M, p. 128.

84-P 1392, Vol. V.

84-P 1950, LM IIIB:1 Courtyard, 1st phase, p. 168.

84-P 2761, Space A-D, floor deposit, p. 201.

87-P 0524, LM IIIB:1, Space G, 23-Floor 9/10, p. 89.

74-P 0198/0260 to 72-P 0176, Vol. V.

74-P 0179, Space E, 9/7-Pit A, p. 208.

84-P 1168, LM IIIA:1, Vol. V.

84-P 1866, Vol. V.

74-P 0207 to 74-P 0158, LM IIIA:1, Vol. V.

71-P 1203, LM IIIB:1, Corridor/Space I, the walls, p. 80.

74-P 0262 to 73-P 0631, LM IIIB:1, Room E, pits in floor, p. 104.

74-P 0263 to 73-P 0625, LM IIIB:1, Room E, levelling deposit, p. 107.

SMALL FINDS

74-TC 015a, *Pls. 228, 256d:1* [636]

Figurine, leg of bed/chair. Good condition. Light buff-whitish, fine, rather soft clay. Light buff, dull slip. Reddish-brown, dull paint. Painted bands down the edges and on the flaring base. In-between, short horiz. transversal lines across leg on one side. Other side unpainted. Possibly of local workshop. One bar on the backside. H 0.031. W 0.02. Th. 0.006.

74-B 001, *Pl. 256d:4* [637]

Bone needle, frg. Only point and lower part remain, broken in two parts and mended. Surface is polished and has obliquely running thin grooves. Traces from abrasives when making the needle or traces of wearing. L 0.022. Ø 0.003.

74-B 002, *Pl. 256d:2* [638]

Bone. Worked into a triangular shape. Polished surface with cutting marks and obliquely running small grooves, probably from abrasives. Mpd 0.032.

74-FR 001, *Pl. 256e*, depth 9.04 [639]

Painted plaster, two frgs. Medium hard, slightly gritted plaster with a smooth surface. Monochrome, red surface. Mpd 0.129. Th. 0.004-7. LM I.

74-S 001, stone vase frg., outside j. [640]

74-S 006 (Mus.no. A 3181), *Pls. 229, 256d:3, c. 519.7/703.95/8.98* [641]

Seal stone, black serpentine. Lentoid, SH vertically or slightly diagonally. Ø 0.017-0.0173. Th. 0.006. SH 0.0022 and 0.0026. Surface slightly worn. A standing pig (boar?) with lowered head in right profile. Above the animal's back a plant motif. Publ.: *CMS V Suppl. 1A*, no. 118. For representations of pigs on soft stone seals cf. *CMS II,3*, no. 168; *V Suppl. 1A*, no. 339; *XI*, no. 177. LM I.

74-S 008, *Pl. 256d:5* [642]

Calcite. Worked into a rectangular thin shape. L 0.021. W 0.008. Th. 0.008.

74-S 012, *Pl. 256d:6* [643]

Whetstone, type 1, frg. Grey schist with brownish and reddish spots and veins. Ø 0.092. Th. 0.011.

74-S 014, *Pl. 256d:7* [644]

Pumice stone. Of a rounded shape. Surface has traces of usage. It is slightly flattened at different sides and has irregularly placed, thin grooves. Ø 0.035.

Outside join

74-S 001 to 74-S 003, Vol. V.

OBSIDIAN

74-OB 036, **Platform rejuvenation flake**, *Pl. 266* [645]; 74-OB 037, **Flake of core's reduction** [645]; 74-OB 038, **Blade** [645]; 74-OB 039, **Bladelet** [645]; 74-OB 040, **Rejuvenation chip**, *Pl. 264* [645]; 74-OB 041, **Debris or waste by-product of core reduction** [645]; 77-OB 210a, **Chip of core's reduction** [646]; 77-OB 210b, **Crested blade** [646]; 77-OB 210c, **Crested bladelet** [646].

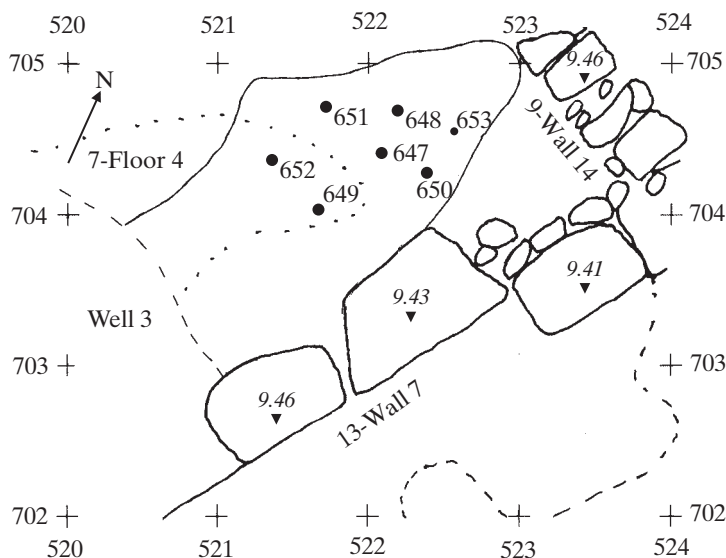

Fig. 77. LM IIIA:2 Space E, 9/7-Pit A, plan with distribution of finds.

BONES

Only a few bones were collected in 1977: They came from adult *Ovis*, *Capra*, caprid, from young *Bos*, while *Sus* was represented with both young and adult animals.

Comments: If not “natural”, most joins go to the LM IIIA:1 pits and to the constructions overlying LM IIIB:1 Room E.

9/7-Pit A (Fig. 77, Pls. 78c, 79a)

Immediately below 7-Floor 4 (Fig. 77) in c. 521.3/704.2 a hole was found going below the scarp 7/8. It proved to belong to a pit, the southeastern border of which had the outer wall 13-Wall 7, and which went up to 705.2 and which stretched east-west from 520.5-523. The pit was excavated at levels 9.27 to 8.63 and probably cut into the above levelling deposit. In places it went down and even below the levels of the floors of the LM IB destruction level. The soil in the pit was loose greenish with many small stones and a few charcoal bits. Only in the lower eastern part the soil was browner and harder. The content of the pit was LM IIIA pottery with some earlier pieces. 39.565 kg of pottery were collected: 8% decorated, 96% kept and 2.1% inventoried. Shapes counted: 1 large stirrup jar, 3 decorated kylikes, 26 undecorated kylikes, 6 amphorae, 9 undecorated cups, 3 undecorated bowls, 49 conical cups, 3 pithos rims, 14 legs of tripod cooking pots, 1 miniature vase, 2 decorated cups, 9 legs of tripod storage jars and 3 footed cups.

POTTERY

74-P 0000, *Pl. 194i:20*

Cup, rim frg. Clay: LW. Slightly marked rim. Int. RB. Ext. RB and alternating shells. Th. 0.003-4. LM IIIA:2.

74-P 0026, *Pls. 133, 195a:13*

Closed vessel, body frg. Clay: light greenish-brown. Ext. blobs on stems? Th. 0.006-7. LM IIIA:2.

74-P 0027, *Pls. 131, 194i:1*

Kylix, rim frg. Clay: LW. Everted rim. Int. RB. Ext. RB, parallel chev-

rons and four body bands. Rim Ø est. 0.16. Th. 0.004. Misfired. (May belong to the same kylix as 74-P 0187 here ins.) LM IIIA:2.

74-P 0028 (+74-P 0060), *Pls. 133, 195a:6*

Jug, body frgs. Clay: brown. Ext. a bird and flowers. Th. 0.002-4. LM IIIA:1/2.

74-P 0029, *Pl. 194i:18*

Cup, rim frg. Clay: light brown. Everted rim. Int. monochrome. Ext. RB and an illegible motif. Th. 0.003. LM IIIA:1/2.

74-P 0140, *Pl. 195b:8*

Kylix, stem frg. Clay: red. Plain ware. Hollowed stem. Stem Ø 0.031. LM IIIA:2.

74-P 0141, *Pl. 194i:17*

Kylix, rim frg. Clay: LW. Everted rim, part of a high-slung, loop-handle. Int. RB. Ext. RB, part of two ending vertical, wavy bands and monochrome handle. Handle 0.010 × 0.015. Th. 0.003-4. LM IIIA:2.

74-P 0142, outside j.

74-P 0163, *Pls. 129, 194i:14*

Cup, rim/body frgs. Clay: LW. Lugged rim, scar from a vertical, strap handle. Int. RB and sponge pattern. Ext. RB, flowers and two body bands pres. Rim Ø est. 0.15. Th. 0.002-3. Burnt. LM IIIA:1/2.

74-P 0175 (+71-P 0338; 71-P 0387/0557; 73-P 0577; 84-P 0463; 01-P 0652/0664), *Pls. 141, 195a:5*

Closed vessel, body frgs. Clay: light red to buff. Yellowish-creamy slip and reddish-brown to brownish-black paint. Two layers of clay visible on the upper part. Ext. foliate band, wavy bands and large ivy leaves. Th. 0.004-12. Burnt both int. and ext. KNO. LM IIIA:1/2.

74-P 0176, *Pls. 133, 195a:3*

Jug, body frg. Clay: light brown. Ext. two body bands, foliate scrolls on mid-body and three body bands below. Th. 0.002-3. LM IIIA:1/2.

74-P 0177, outside j.

74-P 0178, *Pls. 130, 194i:6*

Cup, rim frg. Clay: light brown. Slightly everted rim. Int. monochrome. Ext. RB, a row of dots, irises, dots and concentric semicircles. Rim Ø est. 0.13. Th. 0.003. LM IIIA:2.

74-P 0179, outside j.

74-P 0180, *Pls. 129, 194i:15*

Cup, shallow, rim frgs. Clay: LW. Everted rim. Int. RB. Ext. RB, irises and three thin body bands. Rim Ø est. 0.10. Th. 0.003-4. LM IIIA:2.

74-P 0181, *Pls. 134, 195a:7*

Pyxis, rim/body frgs. Clay: red. White paint. Ext. a broad band between shoulder and body, network on body and a base band. H 0.062. Rim Ø est. 0.120. Base Ø est. 0.152. Th. 0.005. LM IIIA:2.

74-P 0182, *Pls. 135, 195a:14*

Stand, leg frg. Clay: cream. Part of a broad flat leg, ended on one side down to base. Ext. band along edges. Ø est. 0.20. Th. 0.010. LM IIIA:1/2.

74-P 0183 (+76-P 0013; 84-P 0859), *Pls. 130, 194i:19*

Cup/rhyton, rim frgs. Clay: LW. Straight rim. Int. RB. Ext. RB and reed decoration. Rim Ø est. 0.14. Th. 0.003. Burnt. LM IIIA:1.

74-P 0184, *Pl. 195a:2*

Closed vessel, neck/body frg. Clay: light brown. Part of a high neck, a low ridge at base of neck. Int. RB. Ext. monochrome neck, a wavy band and a spiral. Neck Ø est. 0.08-0.09. Th. 0.003-7. LM IIIA:1/2.

74-P 0186, *Pl. 195a:8*

Closed vessel, body frg. Clay: LW. Ext. a hatched loop? and a band around. Th. 0.006-7. LM IIIA:2.

74-P 0187, *Pl. 194i:8*

Kylix, body frg. Clay: LW. Ext. chevrons? and four body bands. Th. 0.003-5. Analysed: local. (May belong to the same kylix as 74-P 0027 here ins.) LM IIIA:2.

74-P 0188, *Pl. 195a:9*

Krater, body frg. Clay: LW. Ext. horiz. rows of zigzag framed by vertical bands. Th. 0.007. LM IIIA:2.

74-P 0189, *Pl. 195a:12*

Closed vessel, body frg. Clay: light reddish-brown. Ext. a flower. Th. 0.004-6. LM IIIA:1/2.

74-P 0190, *Pls. 133, 195a:10*

Closed vessel, base frg. Clay: cream. Torus base. Ext. broad base band and a band above. Base Ø 0.094. Th. 0.006-9. LM IIIA:1/2.

74-P 0191/0257/0284, outside j.

- 74-P 0192, *Pls. 135, 195a:11*
Minoan flask, central disc frag. Clay: light greyish-brown. Ext. a filled lozenge and semicircles, within a circle, which is surrounded by another circle. Max. body Ø est. 0.31. Th. 0.005-9. Burnt int. LM IIIA:1/2.
- 74-P 0193, *Pl. 194i:12*
Kylix, stem frag. Clay: LW. Hollowed stem. Ext. six even bands. Stem Ø 0.036 (not middle). LM IIIA:2.
- 74-P 0194, outside j.
- 74-P 0195 (+77-P 1017), *Pls. 131, 195a:4*
Alabastron, straight-sided, rim/neck/body frag. Clay: light reddish-brown. Small everted rim, two small horiz., strap handles on shoulder. Int. RB. Ext. RB, a band below, on shoulder foliate band framed by bands, tricurved arcs, lozenges and chevrons on body, three body bands below. Handles barred. Pres. H 0.049. Rim Ø est. 0.030. Th. 0.002-4. LM IIIA:2.
- 74-P 0196, *Pl. 194i:23*
Cup, body frag. Clay: light brown. Int. monochrome. Ext. network. Th. 0.003. LM IIIA:2.
- 74-P 0238, *Pl. 194i:22*
Cup, rim frag. Clay: LW. Everted rim. Int. RB. Ext. RB and zigzag. Th. 0.003. LM IIIA:2.
- 74-P 0249, *Pls. 136, 195b:4*
Footed cup, two-handled, rim/body and base frags. Clay: red. Plain ware. Everted rim. Rim Ø est. 0.14. Stem Ø 0.057. Foot Ø 0.073. Th. 0.003-6. Burnt. LM IIIA:2.
- 74-P 0250, *Pl. 195b:6*
Goblet, small, lower body/stem frag. Clay: red. Plain ware. Solid stem. Stem Ø 0.021. Th. 0.003-6. LM IIIA:1/2.
- 74-P 0258, *Pl. 194i:9*
Kylix, rim/body frags. (two different kylikes). Clay: (body frag.) light red with buff core hard fine, (rim frag.) light red. Short, rounded lip, a groove below. Int. and ext. monochrome red. Rim Ø est. 0.14. Th. 0.003-5. Myc IMP. FS 264. LH IIIA:1/2.
- 74-P 0266, *Pl. 195b:1*
Bowl, shallow, rim frag. Clay: red. Plain ware. Everted rim, a complete horiz., strap handle along rim. Rim Ø est. 0.23. Handle 0.009 × 0.020. Th. 0.003-4. Burnt. LM IIIA:1/2.
- 74-P 0267, *Pl. 195b:11*
Kylix, stem/foot frag. Clay: light red. Plain ware. Hollowed stem. Stem Ø 0.025. Foot Ø 0.095. LM IIIA:2.
- 74-P 0268, *Pl. 195b:3*
Ladle, handle frag. Clay: light brown. Plain ware. Part of a high-slung, strap/oval handle. Handle 0.010 × 0.029. LM IIIA:1/2.
- 74-P 0269, *Pl. 195b:2*
Ladle, handle frag. Clay: LW. Plain ware. Part of a high-slung, strap/oval handle. Handle 0.011 × 0.024. LM IIIA:1/2.
- 74-P 0270, *Pl. 194i:16*
Cup, body frag. Clay: buff, hard, fine. Int. monochrome. Ext. two flowers and three body bands. Th. 0.003. KNO. LM IIIA:2.
- 74-P 0271, *Pl. 194i:7*
Cup, rim frag. Clay: light red. Everted rim. Int. monochrome. Ext. RB, zigzag and a body bands pres. Th. 0.003-4. LM IIIA:2.
- 74-P 0272, *Pl. 194i:21*
Juglet, body frag. Clay: LW. Ext. an elaborate lozenge. Th. 0.002. LM IIIA:1/2.
- 74-P 0273, *Pl. 195b:5*
Goblet, small, lower body/stem/foot frag. Clay: red with grey core. Plain ware. Hollowed stem. Stem Ø 0.020. Foot Ø est. 0.062. LM IIIA:1/2.
- 74-P 0274, *Pl. 195b:9*
Cooking dish, rim/body frag. Clay: red with grey core. Coarse fabric. H of rim 0.056. Th. 0.010-13. Th. of body 0.005. Burnt. LM IIIA:1/2.
- 74-P 0276, *Pl. 195b:7*
Kylix, stem/foot frag. Clay: red. Plain ware. Hollowed stem. Stem Ø 0.024. Foot Ø 0.082. LM IIIA:2.
- 74-P 0277 (+78-P 0162), *Pl. 194i:4*
Cup, rim/body frags. Clay: light brown. Everted rim. Int. monochrome. Ext. RB, hatched lozenges and loops; a body band. Rim Ø est. 0.15. Th. 0.003-4. LM IIIA:2.
- 74-P 0278, outside j.
- 74-P 0279, *Pl. 194i:11*
Kylix, body frag. Clay: LW. Ext. a broad, curved, vertical band framed by two thinner. Th. 0.004-7. LM IIIA:2.
- 74-P 0280, *Pl. 194i:10*
Kylix, body frag. Clay: LW. Ext. vertical chevrons? Th. 0.004. LM IIIA:2.
- 74-P 0281, *Pl. 195a:1*
Closed vessel, upper body frag. Clay: light red to light brown. Ext. three ending vertical bands and a thin body band framed by two broader. Th. 0.003-4. LM IIIA:2.
- 74-P 0282, *Pl. 194i:13*
Cup, body frag. Clay: brown. Int. monochrome. Ext. zigzag and filled triangles, a wavy band and two thin body bands below. Th. 0.003-4. LM IIIA:2.
- 74-P 0283 (+74-P 0008/0169), *Pls. 129, 194i:5*
Cup, rim/body frags. Clay: LW. Everted rim. Int. RB and a band close to base. Ext. RB, a low wavy band, alternating shells, two low wavy bands, three body bands, a base band and a band above. Rim Ø est. 0.15. Th. 0.003-5. LM IIIA:2.
- 74-P 0285, *Pl. 194i:3*
Cup, rim frag. Clay: cream. Everted rim. Int. monochrome. Ext. RB, two low wavy bands and alternating shells? Th. 0.003-4. LM IIIA:2.
- 77-P 1998, *Pl. 194i:2*
Cup, rim frag. Clay: LW. Everted rim. Int. RB. Ext. RB and a wavy band. Th. 0.003-4. LM IIIA:2.
- 77-P 1999, *Pls. 138, 195b:10*
Stand, base frag. Clay: light red to light brown. Plain ware. Base is ended on both sides. Base Ø est. 0.17. Th. 0.009-11. LM IIIA:2.
- LM I
- 74-P 0025, *Pl. 138*, **Conical cup**; 74-P 0185, **Closed vessel**; 74-P 0275, *Pl. 195b:12*, **Conical cup**.
- Outside joins
- 74-P 0028 to 74-P 0060, *GSE I*, 66, 67.
 74-P 0142 to 71-P 0203, *GSE III*, 65.
 77-P 0705, LM IIIA:1, Vol. V.
 78-P 0318, Vol. V.
 82-P 1635, LM IIIB:1, Corridor/Space I, floor, p. 74.
 74-P 0175 to 71-P 0338, Rubbish Area North, 5-Pit, p. 248.
 71-P 0387/0557, LM IIIB:1, north of Buildings 1 & 2, north of Room H, p. 192.
 73-P 0577, Space H, 9-Floor 2, p. 212.
 84-P 0463, LM IIIB:1, Room C, floor, p. 58.
 01-P 0652/0664, *GSE III*, 65.
 74-P 0177 to 77-P 0371, *GSE I*, 108.
 84-P 1138, LM IIIA:1, Vol. V.
 74-P 0179 to 72-P 0176, Vol. V.
 74-P 0198/0260, Space E, levelling deposit, p. 207.
 84-P 1168, LM IIIA:1, Vol. V.
 84-P 1866, Vol. V.
 74-P 0183 to 76-P 0013, *GSE III*, 171.
 84-P 0859, Rubbish Area Southeast, 20-Pit L/AJ, p. 226.
 74-P 0191/0257/0284 to 84-P 2406, LM IIIA:1, Vol. V.
 74-P 0194 to 84-P 2462, LM IIIA:1, Vol. V.
 74-P 0195 to 77-P 1017, *GSE III*, 101.
 74-P 0277 to 78-P 0162, LM IIIB:1, Corridor/Space I, the walls, p. 80.
 74-P 0278 to 74-P 0055, LM IIIA:1, Vol. V.
 74-P 0283 to 74-P 0008/0169, *GSE I*, 66, 67.
- SMALL FINDS
- 74-TC 005, *Pls. 231, 257a:4* [647]
Loom weight, type 2a, almost completely pres., only a smaller part missing at top. Clay: gritty, reddish-yellowish with whiter grits. Erased, grooved edge at top. Because of erased edge, object is roughly pear-shaped. Fingerprints visible. H 0.081. W 0.054. Th. 0.030. Ø of SH 0.007. Weight 0.147.
- 74-TC 007, *Pls. 232, 257a:5* [648]
Loom weight, type 2a, frag., pieces missing at lower part and on one long-side. Clay: gritty, reddish-yellowish with whiter grits. Erased, grooved edge at top. Because of erased edge, object is roughly pear-

shaped. Fingerprints visible. H 0.092. W 0.073. Th. 0.029. Ø of SH 0.010. Weight 0.167.

74-TC 008, *Pl. 257a:6* [649]

Loom weight, type 2, frg., about half of weight missing. Clay: fine-grained, reddish-yellowish. Ø 0.068. Th. 0.017. Weight 0.050.

74-TC 015b (**KH Wc 2116**), *Pls. 230, 257a:2* [650]

Roundel, frg. with small part of edge and one surface preserved. Originally of indeterminable shape. Clay: light grey brown, very fine, almost without inclusions. Finely polished. Fingerprints on one surface. No inscription preserved. Along the preserved part of the edge a single seal impression. Pres. Ø 0.025; Th. 0.015. Publ.: Hallager & Vlasaki 1984, 1, n. 2. The seal impression KH 35: one incomplete impression of an oval metal? ring bezel. Only central part of the motif preserved. Pres. L 0.0195. Pres. W 0.013. Impression of medium quality. Motif: on a ground line a couching bull in right profile. Publ.: CMS V Suppl. 1A, no. 139. Reading of roundel: horiz. Publ.: Hallager 1996, II, 149. LM I.

74-MISC 002, *Pl. 257a:3* (see below, Shells) [651]

74-MISC 004, *Pl. 257a:1* [652]

Slag. Of an irregular shape. Pale-grey. Ø 0.061.

OBSIDIAN

74-OB 017, **Flake of core's reduction**, *Pl. 266* [653].

BONES

The pit contained many bones from many different individuals and all species were represented with both young and adult individuals. *Ovis* (27%) represented by at least 7 individuals; *Capra* (17%) represented by at least 4 individuals; caprid (31%) represented by at least 7 individuals; *Sus* (21%) represented by at least 4 individuals and *Bos* (5%) represented by two individuals.

SHELLS

1 *Spondylus* – upper, fresh, no distal end, some pink on exterior, W 0.085, hinge W 0.044 (74-MISC 002).

Comments: Most of the pottery in this pit seems to be connected with liquids. Also the many bones may be significant in this connection.

SPACE F

12-Floor 5, west (*Figs. 73, 78, Pl. 82d*)

Only a small part of this floor was preserved within the square 525.5-526.5/706.35-707.45. On the southwestern side the floor had been cut by the LM IIIB:1 9-Wall 4 (and 12-Wall 9), while at the remaining sides it was cut by LM IIIB:2 pits (12-Pit C and 12-Pit D, cf. *GSE* III, 100-104). The floor, excavated at levels from 9.96 to 9.95, was only 0.01 thick and consisted of a light brown, clayish soil with small pieces of stones embedded. The pottery was LM IIIA with few earlier pieces. 0.800 kg of pottery was collected: 25% decorated, 50% kept and 5.2% inventoried. Shapes were not counted.

POTTERY

77-P 0550, outside j.

77-P 1986 (+77-P 1985), *Pl. 195f:1*

Closed vessel, body frg. Clay: light red. Ext. panelled pattern: horiz. rows of zigzag framed by two vertical bands. Th. 0.009-10. LM IIIA:2.

77-P 1987, outside j.

Outside joins

77-P 0550 to 82-P 0841, LM IIIB:1 Courtyard, floors 2nd phase, p. 163.

84-P 0866, Rubbish Area Southeast, 20-Pit L/AJ, p. 226.

77-P 1986 to 77-P 1985, LM IIIB:1, between Building 1 & 2, lower deposit, p. 175.

77-P 1987 to 77-P 1523, Space F, related, p. 211.

77-P 1129, LM IIIB:1, Room U, the walls, p. 114.

Below 12-Floor 5, west

Below the floor and also covering the whole area towards the northwest we found a deposit of reddish-brown soil with a lot of small stones and pieces of charcoal. It was excavated from levels 9.94 to 9.76/9.61, in places reaching the LM IB destruction level. LM IIIA pottery and some pieces of earlier date. 14.500 kg of pottery were collected: 11% decorated, 64% kept and 0.7% inventoried. Shapes were not counted.

POTTERY

77-P 0998, *Pl. 195f:5*

Stand, leg. Clay: light brown. Slightly splaying leg with one ending side. Ext. bands along the edges. Base Ø est. 0.20. Th. 0.008. LM IIIA:1/2.

77-P 0999, *Pl. 195f:2*

Amphoroid krater, body frg. Clay: light brown. Ext. a curved band and dots, two thin body bands between two broader. Th. 0.008-9. LM IIIA:1/2.

77-P 1379, *Pl. 214e:4*

Pithos, body frg. Sand-tempered fabric variant A. Thick rfb with vertical rope mouldings (7). Th. 0.024. W of rfb 0.030. MpL 0.076. Very worn with flaked off surface. Late MM-LM I/II.

77-P 1380, *Pl. 214d:16*

Pithos, body frg. Sand-tempered fabric variant A. Horiz. high rfb with thick oblique rope mouldings, diagonal plain moulding and parallel to the latter another diagonal high rfb with thick oblique rope mouldings (7+5). Th. 0.013-18. W of rfb 0.023-29. MpL 0.160. Sec. burnt on the ext. Worn. Late MM-LM I/II.

77-P 1381, *Pls. 212, 215a:8*

Pithos, rim frg. Sand-tempered fabric variant A. Light brown slip on int./ext. face. Small rectangular rim, beaked. Th. 0.020-28. Est. rim Ø 0.40. MpL 0.180. Rim damaged and somewhat worn. Late MM-LM I/II.

77-P 1382 (+77-P 1733), *Pl. 215b*

Pithos, 14 body frgs., one with a horiz. handle. Sand-tempered fabric variant A. Not enough preserved to reconstruct shape; base and rim missing. One handle attachment is larger; the handle is ovoid in section and there are no swellings on int. face (L 0.19; W 0.047). Flat horiz. rfb with herring-bone pattern above horiz. handle and below this two horiz. rfb with regular straight-oblique impressions (2D+3). Th. 0.014-16. W of rfb 0.019-36. Slightly sec. burnt on ext. face. Late MM-LM I/II.

77-P 1488, *Pls. 136, 195f:3*

Goblet, small, rim/body/stem frg. Clay: light brown with a red core. Plain ware. Slightly everted rim, a complete, vertical, strap handle, solid stem. Rim Ø est. 0.106. Stem Ø 0.020. Handle 0.005 × 0.015. Th. 0.003-5. LM IIIA:1/2.

77-P 1494, *Pl. 195f:4*

Cup, rim frg. Clay: LW. Everted rim. Int. RB. Ext. RB and tricurved arcs with multiple arcs. Rim Ø est. 0.014. Th. 0.004. LM IIIA:2.

Outside join

77-P 1382 to 77-P 1733, Room C, between layers with stones and floor, p. 50.

OBSIDIAN

77-OB 084a, **Blade** [668]; 77-OB 084b, **Debris or waste by-product of core reduction** [668].

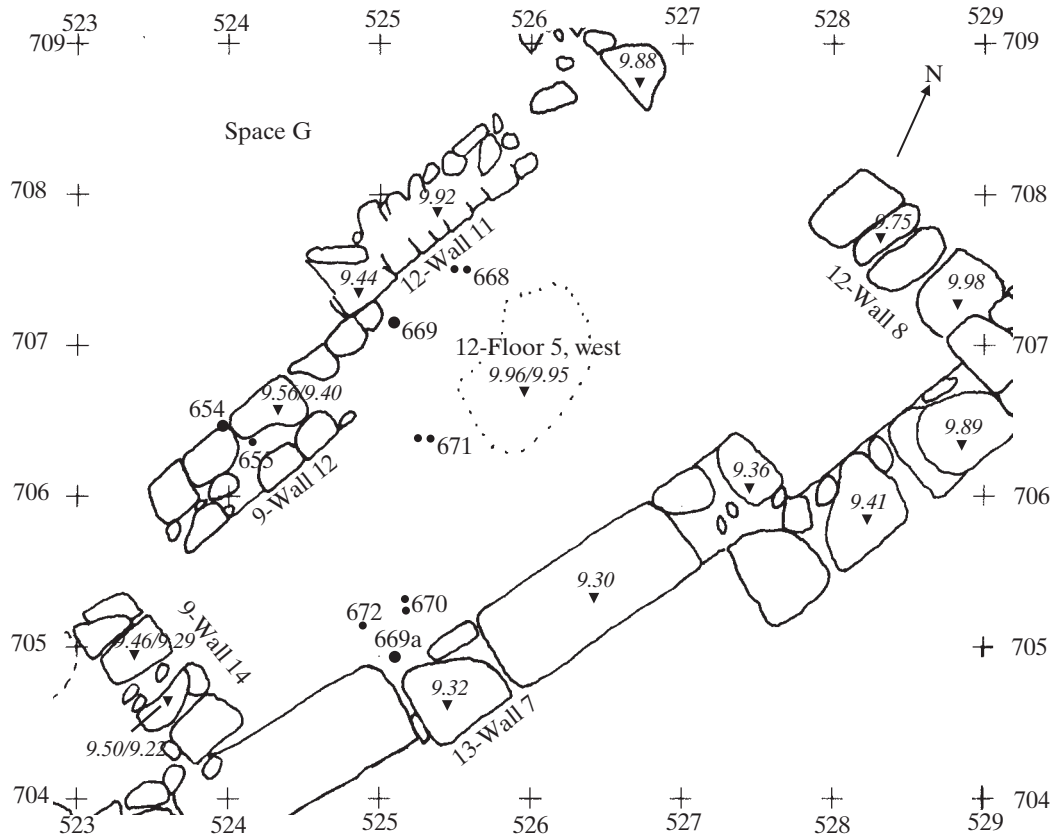

Fig. 78. LM IIIA:2 Space F, plan with distribution of finds.

BONES

From young and adult *Capra*, otherwise only adult animals: *Ovis*, *Ovis/ Capra*, *Bos*, and *Equus caballus*. The horse is represented here by a complete maxillary molars. It seems too large to have come from *E. asinus*, and has therefore provisionally been called *E. cf. caballus*.

Comments: This deposit could very well be considered floor-packing.

Related? (Fig. 78)

The described area covers, by and large, the entire space in the area east of the two wall fragments partly set on top of the LM IIIA:1 pits, 9-Wall 12 and 14. No floor was discovered here, and most of the area was in fact lying below the walls of LM IIIB:1, Rooms E and U. The levels of the small deposits included here follow very roughly the preserved levels of the wall fragments from top at c. 9.50 to a bottom level around 9.26. The soil in this area was not homogeneous but a common characteristic was many patches with rather hard, red, clayish soil mixed with soft brown earth, pieces of charcoal and small stones. In all cases LM IIIA pottery was noted as the latest; but also a few earlier pieces. 12.650 kg of pottery were collected: 17% decorated, 62% kept and 1.7% inventoried. Shapes counted (1974): 1 undecorated kylix and 1 undecorated bowl.

POTTERY

74-P 0122, *Pl. 195i:2*

Cup, rim frg. Clay: LW. Everted rim. Band on top of rim. Ext. RB, shell chain? within wavy bands. Th. 0.003. LM IIIA:2.

74-P 0290, *Pl. 214d:10*

Pithos, body frg. Sand-tempered fabric variant A. Rfb with regular crescent-shaped impressions (2A). Th. 0.014-16. W of rfb 0.026. MpL 0.091. Late MM-LMI/II.

77-P 0745, outside j.

77-P 1004, *Pls. 135, 196a*

Lid, body frgs. Clay: reddish-brown. C. half pres. flanged lid. Ext. concentric circles on top of lid, a band at base of rim. Ext. Ø 0.30. H 0.034. Th. 0.010-12. Burnt. LM IIIA:1/2.

77-P 1006, *Pls. 129, 195i:5*

Cup, miniature, rim frg. Clay: red. Slightly everted rim. Int. monochrome. Ext. RB, tricurved arcs and multiple arcs. Rim Ø est. 0.090. Th. 0.003. LM IIIA:2.

77-P 1007, outside j.

77-P 1501, *Pl. 195i:6*

Cup, body frg. Clay: light red. Ext. foliate scroll, a wavy band and a body band. Th. 0.004. LM IIIA:2.

77-P 1513, *Pl. 195i:1*

Stirrup jar, large, body frg. Clay: light brown. Beg. of a handle. Ext. band around handle/false neck section and chevrons? Th. 0.006-7. LM IIIA:1/2.

77-P 1523 (+77-P 1129; 77-P 1987), *Pl. 195i:4*

Cup, rim/body frgs. Clay: LW. Everted rim, pulled-out for a rough spout. Ext. multiple stem spirals and a body band. Th. 0.003-4. LM IIIA:2.

77-P 1534, *Pl. 195i:7*

Cup, body frg. Clay: LW. Ext. spirals and four thin body bands. Th. 0.002-3. LM IIIA:2.

LM I

74-P 0123, *Pl. 195i:3*, **Open vessel**; 77-P 1005, **Cup**.

EM

77-P 0748, **Cup**.

Outside joins

- 77-P 0745 to 74-P 0054, LM IIIA:1, Vol. V.
 77-P 1007 to 84-P 1032, LM IIIB:1, Rubbish Area Southeast, 20-Pit M, p. 128.
 84-P 1230, Rubbish Area Southeast, 20-Pit Q, p. 234.
 84-P 1246, LM IIIA:1, Vol. V.
 77-P 1523 to 77-P 1129, LM IIIB:1, Room U, the walls, p. 114.
 77-P 1987, Space F, 12-Floor 5 west, p. 210.

SMALL FINDS

- 77-TC 052, *Pls. 228, 256g:1, 525.05/705/9.28* [669a]
Figurine, upper body. Light reddish-brown clay, hard, gritty, semi-coarse. Light reddish-brown slip, dull, thin. No trace of paint. Half upper body with neck and start of arms pres. Roughly modelled. Left arm tip broken off. Possibly a figurine of the Late Psi Type; atypical. H 0.06. W 0.048. Th. 0.013.
 77-S 039, *Pls. 232, 256g:2, 525.1/707.1/9.13* [669]
Stone weight, frg. Almost half of object missing. Quartzite. Centrally placed hole, intentionally pierced through. Sinkers or some other kind of weight. Ø 0.090. Weight 0.338.

OBSIDIAN

- 77-OB 156a, **Flake of core's shaping**, *Pl. 267a:1* [670]; 77-OB 156b, **Debris or waste by-product of core reduction** [670]; 77-OB 160a, **Unfinished simple point on blade** [671]; 77-OB 160b, **Chip of core's reduction** [671]; 77-OB 166, **Flake of core's reduction** [672].

BONES

Very few fragments from young and adult *Ovis*, *Ovis/Capra* and adult *Sus*.

Comments: All joins seem to be "natural".

SPACE G (*Fig. 79*)

Apart from the walls, no LM IIIA:2 deposits were preserved in Space G. The western part of the space was destroyed by the construction of the LM IIIB:1 Building while the eastern part was destroyed by later LM IIIB:1 activities in the lower deposit west and south of 12-Wall 15, cf. above p. 175.

SPACE H

9-Floor 2 (*Fig. 79, Pls. 19c:between 12 and 15, 82c*)

The floor fragment was situated within the square 521-523.3/709.6-712 with the surface at level at 10.09-10.17. To the north it was cut by the Venetian Pit 7, to the east by the Turkish Pit 8, to the south by the Turkish Pit 9, and to the west by a Geometric pit (for all these *GSE* I.2, pls. 7, 8, and 12). Only at a very small restricted area around 523.3/711.5 the floor might have gone up to 12-Wall 15. The deposit overlying 9-Floor 2 was excavated as a levelling deposit below LM IIIB:2 Space P (cf. *GSE* III, 45). The floor itself was a thin pebble floor with clear traces of violent fire. Around 522.5/711 a mud-brick layer c. 0.75 × 0.4 × 0.04 was noted. In the floor LM IIIA was noted and little earlier pottery. Nothing was weighed. Shapes counted: 26 conical cups, 2 tripod cooking pot legs and 1 decorated cup.

POTTERY

- 73-P 0577, outside j.
 73-P 0588, *Pls. 131, 195e:7*
Alabastron, globular, rim/body frg. Clay: light reddish-brown. Low neck with straight rim, a ridge on upper body. Int. RB. Ext. Broad RB covering ridge, a curved band below. Rim Ø est. 0.16. Th. 0.004-7. LM IIIA:2.

LM I

- 73-P 0575, **Cup**; 73-P 0576, **Closed vessel**; 73-P 0766 (Mus.no. 3805), **Jug**.

Outside joins

- 73-P 0577 to 71-P 0338, Rubbish Area North, 5-Pit, p. 248.
 71-P 0387/0557, LM IIIB:1, north of Buildings 1 & 2, north of Room H, p. 192.
 74-P 0175, Space E, 9/7-Pit A, p. 208.
 84-P 0463, LM IIIB:1, Room C, floor, p. 58.
 01-P 0652/0664, *GSE* III, 65.

OBSIDIAN

- 73-OB 037, **Flake of core's reduction** [660]; 73-OB 038, **Chip of core's reduction** [660].

Levelling deposit (*Fig. 79, Pl. 19c:15*)

In the levels below the floor, in the northern part, a hard yellowish soil was noted and to the south a loose, yellow-grey earth. The bottom of these deposits was reached at 10.01/9.76. The pottery appeared to be LM IIIA with some earlier pieces. 1.500 kg of pottery was collected: 8% decorated, 79% kept and 6.5% inventoried. Shapes counted: 2 large stirrup jars, 1 decorated and 1 undecorated kylix, 1 decorated jug, 14 conical cups, 1 tripod cooking pot leg, 1 decorated cup and 3 footed cups.

POTTERY

- 73-P 0272, *Pl. 195e:2*
Krater, body frg. Clay: LW. Ext. curved bands and two vertical rows of short strokes (flowers?). Th. 0.004-7. LM IIIA:2.
 73-P 0273, *Pl. 195e:5*
Cup, body frg. Clay: light brown. Int. monochrome. Ext. a spiral. Th. 0.003. LM IIIA:2.
 73-P 0312, outside j.
 73-P 0313, *Pl. 195e:3*
Stirrup jar, medium-sized, false neck/disc and body frg. Clay: light red. A small knob on edge of disc. Ext. a broad band along edge of disc, an inner circle of dots and a dot in the middle. Bands along edge of handle and barred on top, thin and broad curved bands on upper body. Disc Ø est. 0.057. Handle 0.018 × 0.024. Th. 0.005-8. LM IIIA:1/2.
 73-P 0314, *Pl. 195e:6*
Closed vessel, body frg. Clay: LW. Ext. a flower? and a broad body band. Th. 0.006-7. LM IIIA:2.
 73-P 0315, *Pl. 195e:9*
Cup, body frg. Clay: light brown. Ext. RB?, alternating arcs with multiple arcs and a row of short strokes. Th. 0.004-6. LM IIIA:2.
 73-P 0427 (+77-P 0696), *Pl. 195e:1*
Stirrup jar, large, upper section frg. Clay: red with a partly greyish-brown core. Cream paint. Ext. unpainted on top of disc, handles barred, a band around neck/handle section, chevrons, on upper body band. Disc Ø est. 0.052. Handle 0.017 × 0.026. Th. 0.006-8. Analysed: local. LM IIIA:1/2.
 73-P 0429, outside j.
 73-P 0430, *Pls. 132, 195e:8*
Krater, lower body/foot frg. Clay: LW. Splaying foot. Int. a broad band around base and two bands above. Ext. two lower body

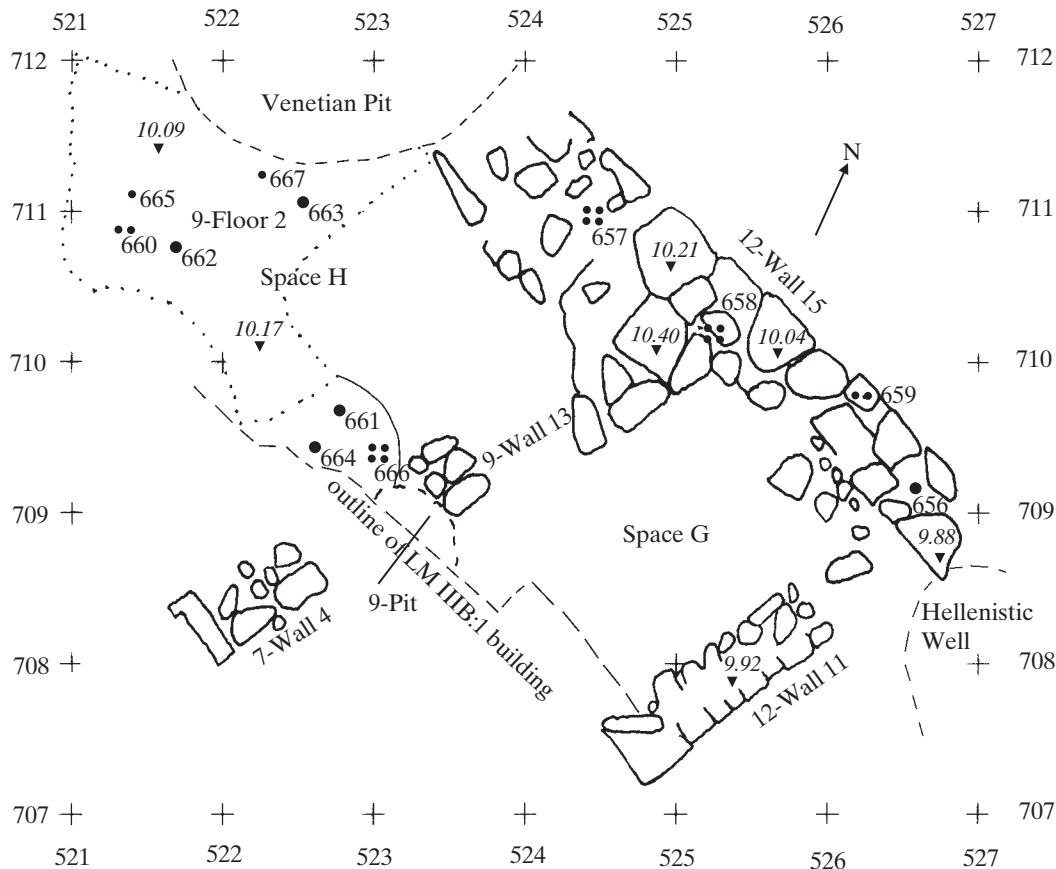

Fig. 79. LM IIIA:2 Spaces G and H, plan with distribution of finds.

bands and monochrome stem. Stem \varnothing 0.04. Th. 0.005-8. Burnt. LM IIIA:2.

73-P 0431, *Pls. 135, 195e:4*

Askos, body frg. Clay: light brownish-grey. Upper part of an askos with a central handle. Top section made separately. Ext. handle barred, faint traces of paint on body. Handle 0.009×0.014 . Th. 0.004-6. LM IIIA:1/2.

73-P 0437, *Pl. 195e:11*

Kylix, stem frg. Clay: red. Plain ware. Hollowed stem. Stem \varnothing 0.026. LM IIIA:2.

73-P 0438, *Pl. 195e:10*

Kylix, lower body/stem frg. Clay: light brown. Hollowed stem. Ext. monochrome stem. Stem \varnothing 0.027. LM IIIA:2.

LM I

73-P 0162, **Conical cup** (analysed); 73-P 0426, outside j.; 73-P 0428, outside j.; 73-P 0439a, **Cup** (analysed); 73-P 0439b, **Cup** (analysed).

Outside joins

73-P 0312 to 84-P 1178/2341, LM IIIA:1, Vol. V.

73-P 0426 to 76-P 0009/0016/77-P 1321, Rubbish Area North, 11-Pit G, p. 242.

73-P 0427 to 77-P 0696, Rubbish Area North, 11-Pit G, p. 242.

73-P 0428 to 77-P 1299, LM I, Vol. VI.

77-P 0729, Rubbish Area North, 11-Pit G, p. 243.

73-P 0429 to 73-P 0555, intrusive in Vol. VI.

77-P 0767, intrusive in Vol. VI.

77-P 1340, Rubbish Area North, 11-Pit G, p. 242.

SMALL FINDS

73-B 004, *Pl. 257c:1, $\Delta\epsilon/522$ [661]*

Bone, frg. Worked into a pyramidal shape with obliquely slanting

flat bottom and flat top. One of long sides slightly concave. Polished surface. L 0.050. Th. 0.008.

73-S 028, *Pls. 229, 257c:2 [662]*

Bead/Button/Spindle whorl, completely pres., only slightly chipped at bottom. Brownish/violet – black steatite. Of a concave, conical, shanked shape. H 0.010. \varnothing 0.006-20. \varnothing of SH 0.003.

73-S 282, *Pls. 228, 257c:3 [663]*

Stone vase, rim frg. Possibly a bowl with everted rim and carinated profile. Peridotite with white and green patches (inclusions of a mineral with high magnesium content; probably magnesite). H 0.018. Est. \varnothing 0.08. Th. 0.03-0.04. Analysed. Late EM II-MM I/II. Survival. Warren 1969, type 8.

73-S 283, *Pl. 262d [664]*

Stone weight, fish-net sinker. Rather well pres., some pieces missing. Buff coloured limestone. Rounded stone with a centrally placed intentionally pierced hole. Hole is more worn on one side. \varnothing 0.134.

OBSIDIAN

73-OB 035, **Rejuvenation chip**, *Pl. 264 [665]*; 73-OB 046, **Flake of core's shaping**, $\Delta\epsilon/522$ [666]; 73-OB 047, **Debris or waste by-products of core reduction**, $\Delta\epsilon/522$ [666]; 73-OB 049, **Bladelet**, $\Delta\epsilon/522$ [666]; 73-OB 050, **Blade**, $\Delta\epsilon/522$ [666]; 73-OB 104, **Blade**, *Pl. 269b:6, $\Delta\gamma/522$ [667]*.

BONES (all from below the burnt 9-Floor 2)

There several bones from *Homo*, one from *Avis*, and few from *Ovis/Capra*. A *tarso-metatarsus, sin.* representing a bird about the size of a crow was preserved. As far as concerns *Homo*: the skeletal remains belonged to an adult, possibly an aged woman. The skull fragments include a large section of the *os frontale* with well-preserved *glabella* and *pars supra orbitalis sin.*, both diagnostically female, while the sinuses are relatively small and likewise suggestive of female sex. A small part of the fronto-nasal suture is preserved, synostosis of which was well ad-

vanced indicating an aged individual. Another six skull fragments survived from the crown of the skull, but a more detailed description cannot be given. There are 14 larger and smaller fragments of limb bones, only two of which could be definitively identified, namely the right(?) femur medial condyle and right(?) tibia medial malleolus.

Comments: The most spectacular finds from this deposit are the cranium and long bones of an older woman. It is unlikely that there could have been a burial inside the settlement and the soil description does not indicate a destruction debris. It is therefore most likely that the skeleton parts were secondarily deposited. Considering the amount of LM I pottery and the join (73-P 0429) to an otherwise undisturbed part of the LM IB destruction level, it may perhaps be tempting to suggest that here we are dealing with a victim of the LM IB destruction (and not of the LM IIIB:1 destruction as erroneously suggested in *GSE* III, 53). In connection with this, one should note the four joins to 11-Pit G (below p. 242), that cut deep into the LM IB destruction level of House I, Room E.

9-Pit (*Fig. 79, Pl. 83a*)

A small pit had cut through the wall between Spaces G and H. It was situated up against the LM IIIB:1 9-Wall 2a within the square 523-523.6/708.5-709.15. Description of soil and levels are missing, but it is clearly seen on *Pl. 83a* to be cutting into the partition wall of LM IB staircase. Few sherds which appeared to be LM III. Nothing was weighed. Shapes counted: 1 large stirrup jar, 2 conical cups, 1 pithos rim, 1 tripod cooking pot leg and 2 footed cups.

POTTERY

73-P 0282, *Pl. 195g:1*

Stirrup jar, large, false neck/disc frg. Clay: light reddish-brown. Ext. band along edge of disc and handle, barred on top. Disc Ø est. 0.070. Handle 0.017 × 0.029. Analysed: local. LM IIIA:1/2.

73-P 0283, *Pl. 195g:2*

Cup, base frg. Clay: LW. Flat base. Int. a broad band around base, a band above. Ext. broad band close to base. Base Ø est. 0.040. Th. 0.003-6. LM IIIA:1/2.

Comments: This pit seems to have been destroyed by the construction of the LM IIIB:1 9-Wall 2a which would date the pit prior to the construction of the wall, while on the other hand the pit is cut into the wall dividing the Spaces H and G. The pit thus seems to represent a period when the LM IIIA:2 building had become disused, but to be earlier than the construction of the LM IIIB:1 building.

CONSTRUCTIONS

9-Wall 12 and 9-Wall 14 (*Fig. 78, Pls. 79b-c, 80a-c*)

As mentioned above these two small wall fragments, preserved to one course height, were new constructions in the LM IIIA:2 period. The one running NE-SW, 9-Wall 12 (*Pls. 80a-c*) was preserved at a length of 2.0 and width 0.55 while the height was c. 0.2. It was excavated at levels 9.56 to 9.40.

Height and width were the same for the NW-SE running wall, 9-Wall 14 (*Pl. 79b-c, 80c*) which was only preserved to a length of 1.3. This wall was excavated at levels 9.46 to 9.29/9.22. Both walls were built by relatively large, mainly unworked stones with small stones in-between and set in a grey to brown, very dry earth mortar. 9-Wall 12 was of the usual sandwich type while the preserved part of 9-Wall 14 had most stones running all the way across the width of the wall. The few diagnostic sherds appeared to be of LM I date but one or two LM IIIA were also noted. Nothing was weighed. Shapes were not counted.

POTTERY

77-P 1113, *Pl. 195c:1*

Goblet, small, lower body/stem and foot frg. Clay: red. Plain ware. Solid stem. Stem Ø 0.021. Foot Ø est. 0.055. LM IIIA:1/2.

77-P 2057, *Pls. 212, 216e:6*

Pithos, rim frg. Sand-tempered fabric variant A. Burnt creamy slip or paint on ext. face. Triangular rim with pointed "beak" at the ext. face. Th. 0.014. Est. rim Ø 0.40. MpL 0.160. Sec. burnt on the ext. face. Late MM-LM I/II.

77-P 2064, outside j.

Outside join

77-P 2064 to 78-P 0357, LM I, Vol. VI.

Bedding (*Fig. 78*)

A thin layer 0.05-0.10 was excavated as a bedding below 9-Wall 12 and 9-Wall 14. The soil here was light, greyish to dark brown, and below it the LM IB destruction level and an LM IIIA:1 pit were found. The pottery consisted mainly of LM I with a few LM IIIA pieces included. Nothing was weighed. Shapes were not counted.

POTTERY

77-P 1026, *Pls. 131, 195c:2*

Goblet, large, lower body frg. Clay: brown. Int. monochrome with a reserved circle at base. Ext. a central, broad, curved band framed by two thinner and sponge pattern. Th. 0.005-8. LM II/IIIA:1.

77-P 2058, *Pl. 216f:11*

Pithos, body frg. Gravel-tempered fabric variant trickle paint. Horiz. rfb with regular and deep crescent-shaped impressions of overlapping tongues (2E). Th. 0.018. W of rfb 0.038. MpL 0.075. Worn. MM? 77-P 2059, *Pl. 216f:9*

Pithos, lid frg. Gravel-tempered fabric. Rough lower face, smooth ext. face. Rounded edge with the beginning of a tap for a handle? Th. 0.014. Est. lid Ø 0.60. MpL 0.168. LM III.

SMALL FINDS

77-M 084, *Pl. 256f*, depth 9.27 [654]

Bronze bead, frg. Very corroded, light green with light spots. Of a rounded shape. No SH visible. Ø 0.011.

OBSIDIAN

77-OB 228, **Flake of core's reduction** [655].

12-Wall 15+12 Wall 8 (*Figs. 78-79, Pls. 8, 22a, 24b (top of LM I-III A walls), 81-82b*)

This wall was excavated over different years and always at the corners of scarps (*Pl. 81a*) and trenches (*Pl. 8*) and imme-

diately below modern walls. For this reason its existence was not recognized during the excavation, but rather noticed as “stones” or a “concentration of stones” in the respective areas. The existence of a wall resting on the southwestern wall of LM I House I Room M and the southern part of the Corridor seems, however, to be certain from existing plans and photographs (*Pls. 81d, 82a-b*), and it could actually be followed to a length of 4.40 from northwest where it was cut by a Venetian pit, to southeast where it was cut by a Hellenistic well (*GSE I, 202-204*). As the wall was built, the outer facade of the LM III wall must have been towards the northeast which indicates the existence of rooms on the southwestern side. Furthermore, there is a clear indication that it formed a corner with 9-Wall 13 at 525.25/709.95 which divided the southwestern side into Space H (with a floor fragment preserved), and Space G (*Fig. 79*). The width of the wall is *c.* 0.60. Top of the wall was 10.40/10.21 and it is followed all the way down to the top of the destruction level. The stones were a mixture of reused blocks and unworked stones while it seemed to have a greyish-brown clay mortar. The pottery from the excavation of the wall and the cleanings were almost entirely LM I and earlier, while a few later sherds were also noted. From the catalogue below only 77-P 1617 need not be from the wall. 10.890 kg of pottery were collected: 6% decorated, 60% kept and 2.1% inventoried. Shapes counted (1973): 1 undecorated jug and 7 conical cups.

POTTERY

77-P 0756, *Pl. 195d:2*

Jug, collared, rim/spout frg. Clay: LW. Straight rim, a complete, open spout. Int. RB. Ext. RB, a band below, a band around base of spout, three bands below and a broad band at tip. Pres. L 0.058. Th. 0.005-6. Burnt. LM IIIA:2.

77-P 1617, *Pl. 195d:3*

Closed vessel (small, globular stirrup jar?), upper body frg. Clay: buff turning light red towards ext., hard, fine. Ext. multiple stem, curved (FM 19), three thin bands between two broader, three thin and a broad band below. Th. 0.005. Myc IMP. FS 171? LH IIIA:2.

78-P 0428, *Pls. 130, 195d:1*

Cup, rim/body frg. Clay: light brown. Everted rim. Int. monochrome. Ext. RB, a row of S's, a band, festoons with irises int. and multiple arcs in-between, one body band pres. Rim Ø est. 0.15. Th. 0.004-5. LM IIIA:1.

LM I

73-P 0230, **Conical cup**; 73-P 0231, **Conical cup?**; 73-P 0232, **Conical cup**; 73-P 0873, **Conical cup**; 78-P 0426, **Open vessel**; 78-P 0429, **Open vessel**.

MM

73-P 0326, **Open vessel?**; 73-P 0868, **Cup**; 73-P 0869, **Jug**; 73-P 0870, **Jar**; 73-P 0871, **Jug**.

EM

73-P 0872, **Plate**; 78-P 0427, **Open vessel**.

SMALL FINDS

78-AR 005, *Pl. 257b* [656]

Wattle and daub, frg. with three surfaces pres., almost rectangular shape. Clay brick-red, soft, finely gritted; mixed with fava. This piece has probably been pressed up against two pieces of wood set at a right angle. One of the wooden pieces must have had (an unused) mortise; the impression of which is clearly seen on one of the sides. Also imprint of wood; the end of which was cut at an angle of *c.* 60°. The surface, not pressed against wood, was clearly smoothed by fingers. L 0.125. W 0.052. Th. 0.053. Dim. of mortise 0.055 × 0.017. Probably LM I.

OBSIDIAN

73-OB 088, **Rejuvenation chip** [657]; 73-OB 090, **Chip of core's reduction** [657]; 73-OB 091, **Bladelet**, *Pl. 269c:12* [657]; 73-OB 092, **Bladelet**, *Pl. 269b:5* [657]; 77-OB 122a, **Flake of core's shaping**, *Pl. 267a:2* [658]; 77-OB 122b, **Chip of core's reduction** [658]; 77-OB 122c, **Debris or waste by-product of core reduction** [658]; 77-OB 122d, **Rejuvenation chip** [658]; 77-OB 165a, **Platform rejuvenation flake** [659]; 77-OB 165b, **Bladelet** [659].

BONES

Two small bones from young *Sus* identified.

Comments: There is a low percentage of decorated pottery. The existing part of 12-Wall 11 is a construction of the LM I period and it is unexcavated (cf. Vol. VI). Nothing of the supposed LM IIIA:2 superstructures is preserved.