

# THE LATE MINOAN IIIB:1 SETTLEMENT

## STRATIGRAPHY AND CATALOGUES

### BUILDING 2

#### BUILDING 2 (*Figs. 57-60, Pls. 21c:5-6, 58-59*)

The layout of Building 2 was not really understood until the rescue excavations in Parodos Kanevaro in 1990 (Hallager & Tzedakis 1988, 39-42, fig. 20 and here *Fig. 1*) and the further investigations in 2005. The building proved to measure at least 13.3 m (N-S) and at least 10 m (E-W) in which we have, so far, found parts of at least seven different rooms. Southwest of the building, an open courtyard was excavated (with 14 floor levels) surrounded by a (presumably) low wall. The Courtyard appeared to be terraced and an entrance to Building 2 was found from the upper terrace in 534-534.5/708-709.

In the 1970-87 and 2001 excavations only the Courtyard, a narrow Room B1 and a small part of Room A was excavated.

#### ROOM A (*Figs. 57, 58, Pl. 58a-c*)

Due to the 1990 excavation we now think that Room A may have measured (internally) *c.* 6 × at least 4.8 and it appears that the room may have had two floors with a difference in levels of almost 0.5. The upper floor was discovered in 1982 in the southeastern corner and in 1990 in the northeastern corner – both well constructed pebble floors which (if we are really dealing with one room) sloped *c.* 0.13 towards the south from 10.36 to 10.23. At some point during LM IIIB:2 (see *GSE III*, 176-178) a rubbish pit was dug through the upper floor of the room north of 712.25 since it was not recognized in the trial test excavated in 532.5-534/712.5-714. The lower floor was, however, found at level 9.74 which is also the approximate bottom of the southwestern wall of the room, 19-Wall 7. Until further investigations are carried out we thus argue two LM IIIB:1 phases of Room A. The room was not in use during LM IIIB:2 (as also shown in the 1990 excavation), while the top of the 19-Wall 7, might have been preserved to a slightly higher level than the LM IIIB:2 floor levels to the south. Of the two floors in Room A only the “floor deposits” were excavated.

#### Above upper floor (*Figs. 57, 58, Pl. 58a-b*)

The “floor deposit” was stratified below the Gazoseria (*GSE I*, 86-94) and LM IIIC, Pits E/F (*GSE II*, 96) and it was seen

to continue below the LM IIIC slabbed floor of Building 2, Room A. No test trench has been made in the floor. The floor itself was an extremely well constructed pebble floor, laid tight with very small pebbles: much smaller than usual. The deposit above the floor (*c.* 0.08 thick) was described as red, dry and rather hard soil.

LM IIIB:1 was noted as the latest pottery. Furthermore, there were a few sherds LM IIIA, LM I and MM (coarse). 0.420 kg of pottery was collected: 15% decorated, 100% kept and 3.3% inventoried. Shapes were not counted.

#### POTTERY

82-P 0818, *Pl. 174c:8*

**Bowl**, body frg. Clay: light brown. Int. two body bands. Ext. two bands. Th. 0.006-7. LM IIIB:1.

#### SMALL FINDS

82-MISC 020, *Pl. 245b* (see below, Shells) [358]

#### BONES

Very few bones from adult and young *Ovis* and *Sus*.

#### SHELLS

1 *Murex* – fresh, L 0.0385 (82-MISC 020).

#### Above lower floor (*Figs. 57, 58, Pls. 21c:5-6, 58c*)

The lower floor was a beaten earth floor in which one small isolated slab stone was found. The soil above the floor was hard, fat, red (burnt?) with a few small stones and bits of *kouskouras* and fragments of slab stones. Apparently it was part of a destruction level since some larger bits of charcoal were found immediately above the floor.

Among the pottery were, apart from LM IIIB and IIIA, noted a few LM I and MM pieces. 1.300 kg of pottery was collected: 6% decorated, 55% kept and 8.6% inventoried. No shapes to be counted.

#### POTTERY

87-P 0137, *Pl. 174c:3*

**Jar**, wide-mouthed, body frg. Clay: red with grey core. Creamy-yellowish slip and reddish-brown paint. Int. accidental dots. Ext. a spiral and two body bands. Th. 0.007. Burnt. LM IIIB:1.

87-P 0138, *Pl. 174c:5*

**Closed vessel**, body frg. Clay: yellowish-red. Ext. three high, wavy bands. Th. 0.008-10. Burnt. LM IIIB:1.

87-P 0139, *Pl. 174c:4*

**Goblet**, small, rim frg. Clay: light brown. Plain ware. Slightly everted

Fig. 57. LM IIIB:1 Building 2, Rooms A, B1, plan with distribution of finds.

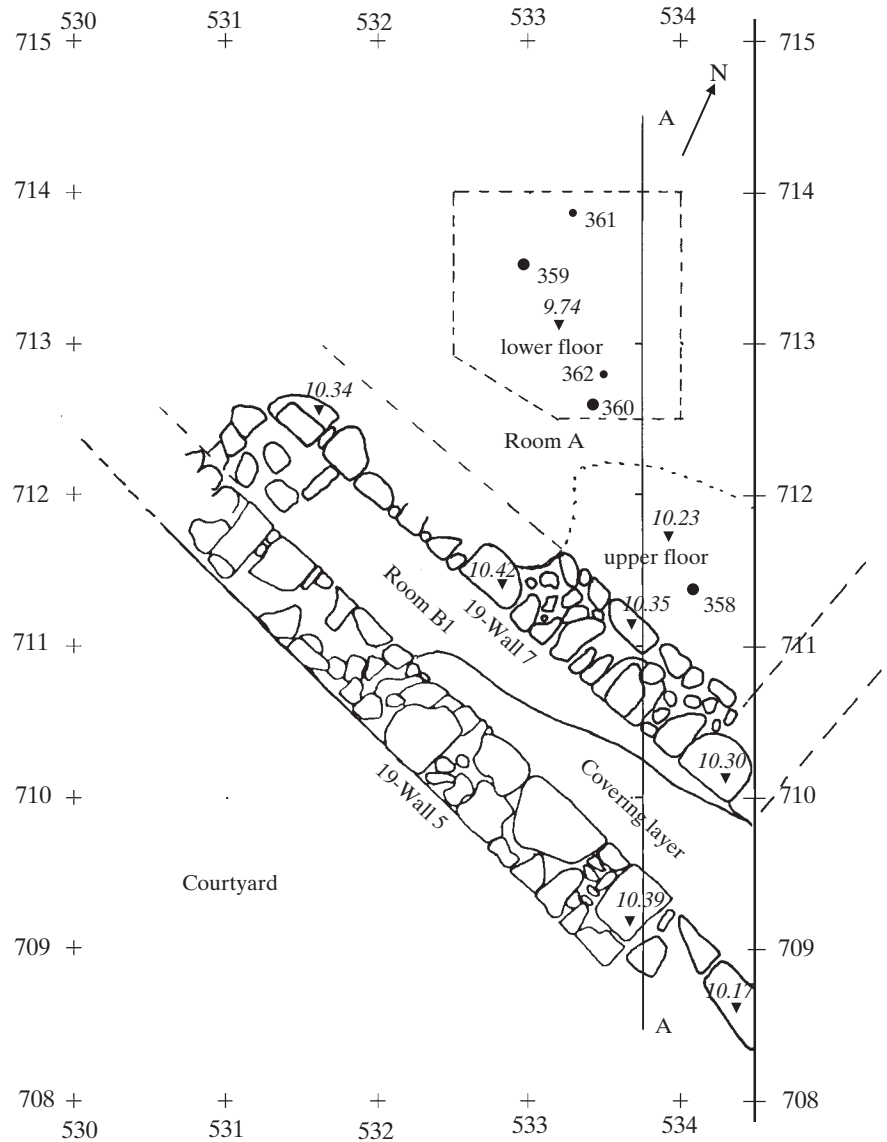
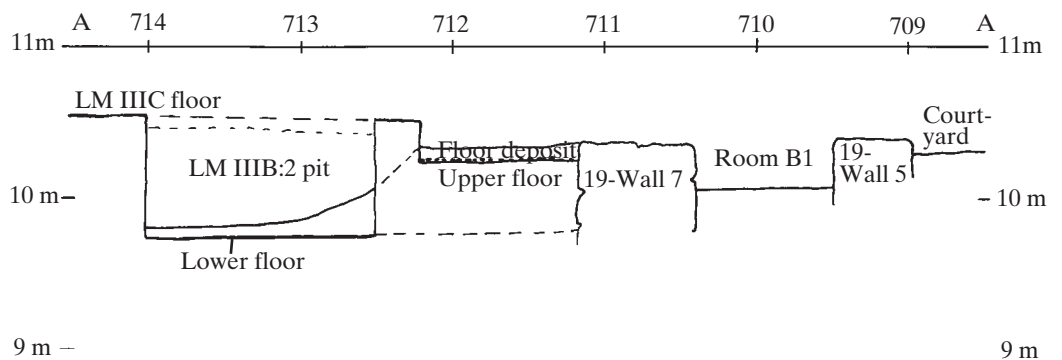

Fig. 58. LM IIIB:1 Building 2, section A-A; cf. Fig. 57.



rim, a complete, vertical, strap handle from rim. Handle 0.006 × 0.020. Th. 0.004-5. LM IIIA:2.  
 87-P 0140, *Pls. 120, 174c:2*  
**Storage jar**, rim/body frag. Clay: red. Coarse fabric. Everted rim, a complete, horiz., roll handle below rim. Rim Ø est. 0.35. Handle 0.020 × 0.025. Th. 0.009-10. Burnt. LM IIIA:2/B:1.  
 87-P 0141, *Pls. 125, 174c:7*  
**Drain**, end corner. Clay: red with grey core. Coarse fabric. Irregular flat base, body in straight angle to base. The frag. is ended along one

side both base and body. Int base is sloping toward opening. Pres. H 0.07. Th. body 0.016-17. Th. base 0.026-30. LM IIIB:1?  
 87-P 0570, *Pl. 174c:1*  
**Closed vessel**, body frag. Clay: LW. Ext. alternating arcs. Th. 0.003. LM IIIB:1.  
 87-P 0571, *Pl. 174c:6*  
**Amphoroid krater**, neck frag. Clay: LW. Ext. a wavy band. Th. 0.007-10. LM IIIB:1.

## MM

87-P 0136, **Cup**.

## SMALL FINDS

87-FR 001, *Pl. 246a*, 533.43/712.60/9.83 [360]

**Painted plaster**, two frgs. Hard, gritted plaster; gray in colour due to burning. Smooth surface covered with a yellowish-white wash. Mpd. 0.034. Th. 0.004-14. LM IIIA:2.

## OBSIDIAN

87-OB 007, **Debris or waste by-product of core reduction**, 533.50/712.82/9.75 [362].

*Comments:* Two small finds, a loom weight 87-TC 002 [359] (*Pls. 226, 246a:1*) and an obsidian 87-OB 006 [361] were excavated with the overlying LM IIIB:2 rubbish deposit and described in *GSE III*, 176-178, while they were actually noted as lying on the lower floor (to which they should probably be rightly ascribed).

If correctly interpreted, the two floors of this room are unusual for LM III architecture, having a difference of 0.5 in levels. The explanation may perhaps be that a local destruction within LM IIIB:1 caused the sealing of the earlier floor rather than a new one laid on top of the old one. It should be noted that a similar phenomenon was also noted in the neighbouring Room B during the 2005 excavations (*Fig. 1*).

ROOM B1 (*Figs. 57-60, Pl. 59a-d*)

What we have called Room B1 is a curious narrow corridor-like room found west of the entrance to the building from the Courtyard. It is situated within 531-534.5/709-712.5. The room measures (from west of the door)  $3.9 \times 0.72/0.45$  getting narrower towards the west. Fragments of four floors were found in this room, but no traces were found west of 532, i.e. in the western 1.7, where only what appeared to be a fill was found. No finds were made on the floors to indicate the possible use of this room.

The stratigraphy within the room in the LM IIIB:1/A:2 period is as follows: a layer was covering the latest floor and to a certain extent a pit, 19-Pit O, which in the centre of the room was dug through the floors and the fill in the west part. Then followed the four fragmentary floors (19-Floor 10 and 19-Floor 11 (with a shallow pit below) of the LM IIIB:1 period and 19-Floor 9 and 19-Floor 41 of the LM IIIA:2 period. In the eastern part, below the lowest floor, a pit/*vothros* was found (cf. below p. 236). None of the LM IIIB:1 floors can be directly related to the two found in Room A, while, on the other hand, they can be related to the floors found in Room B in 1990 (*Fig. 1*) and 2005, and to a certain extent to the floors of the Courtyard and the two different thresholds (see further below).

Covering layer (*Figs. 57, 59, 60, Pl. 59a*)

This layer stretched roughly from 532 eastwards and consisted of a dark red-brown, rather loose soil with a lot of stones at the bottom of the deposit which was found on levels 10.28 to 10.06.

The pottery was mainly LM IIIA with some LM IIIB sherd and few earlier pieces. 5.525 kg of pottery were collected: 12% decorated, 86% kept and 2.3% inventoried. Shapes were not counted.

## POTTERY

82-P 0504 (+82-P 0308; 82-P 0468), *Pls. 94, 174d:9*

**Bowl**, rim/frgs. Clay: light brown. Slightly marked rim. Int. RB. Ext. RB, two rows of shell chains and a body band. Rim  $\emptyset$  est. 0.16. Th. 0.004-5. LM IIIB:1.

82-P 0505, *Pl. 174d:4*

**Juglet**, upper body frg. Clay: LW. Ext. a band, three rows of dots and two body bands pres. below. Th. 0.002-3. LM IIIA:2/B:1.

82-P 0506, *Pls. 99, 174d:2*

**Alabastron**, small, straight-sided, rim frg. Clay: light brown. Low neck, everted rim. Int. RB. Barred on top of rim. Ext. RB and foliate band. Rim  $\emptyset$  est. 0.060-0.065. Th. 0.002-3. LM IIIA:2/B:1.

82-P 0507, *Pl. 174d:1*

**Kylix**, stem/foot frg. Clay: LW. Hollowed stem. Ext. monochrome. Stem  $\emptyset$  0.023. LM IIIB:1.

82-P 0508, *Pl. 174d:3*

**Stirrup jar**, large, disc frg. Clay: light reddish-brown with grey core. Yellow cream paint. Scar from a handle. Ext. bands from handle meeting on top of disc. Handle  $0.018 \times 0.039$ . LM IIIA:2/B:1.

82-P 0510, *Pl. 174d:8*

**Ladle**, handle frg. Clay: light brown. Plain ware. Beg. of a high-slung, strap/oval handle. Handle  $0.016 \times 0.028$ . LM IIIA:2/B:1.

82-P 0511, *Pl. 174d:5*

**Footed cup**, one-handled, lower body/stem/foot frg. Clay: light brown. Plain ware. Stem  $\emptyset$  0.028. Foot  $\emptyset$  0.061. Late type. LM IIIB:1.

82-P 1678, *Pl. 174d:7*

**Closed vessel**, base frg. Clay: red. Splaying base with a moulding. Ext. monochrome. Base  $\emptyset$  est. 0.07. Burnt. LM IIIA:2/B:1.

## EM

82-P 0509, **Open vessel**.

## Outside joins

82-P 0504 to 82-P 0308, *GSE III*, 98.

82-P 0468, *GSE III*, 107.

## OBSIDIAN

82-OB 033a, **Debris or waste by-product of core reduction** [363]; 82-OB 033b, **Blade** [363]; 82-OB 043a, **Flake of core's shaping** [364]; 82-OB 043b, **Bladelet**, *Pl. 265* [364].

## BONES

Bones from adult *Sus*, *Ovis*, *Capra* and *Ovis/Capra*.

## SHELLS

1 *Murex* – fresh, lacks apex, medium. 1 *Glycymeris* – water-worn, 1 *Spondylus* – lower, fresh.

*Comments:* The many stones found in this layer may perhaps have derived from destroyed walls.

19-Pit O (*Fig. 60, Pl. 59b*)

The pit is found east of 531.7 and all the way up along the northern wall, 19-Wall 7, of the room. It was found at levels 10.15 to 9.87. The soil was rather loose, red on top more dark brown further down with many stones and some pebbles and some bones. The pottery was mainly early LM IIIB and late LM IIIA with a few earlier pieces. 4.310 kg of pottery were collected: 11% decorated, 82% kept and 2.9% inventoried. Shapes were not counted.

Fig. 59. LM IIIB:1 Building 2, Room B1, plan with distribution of finds.

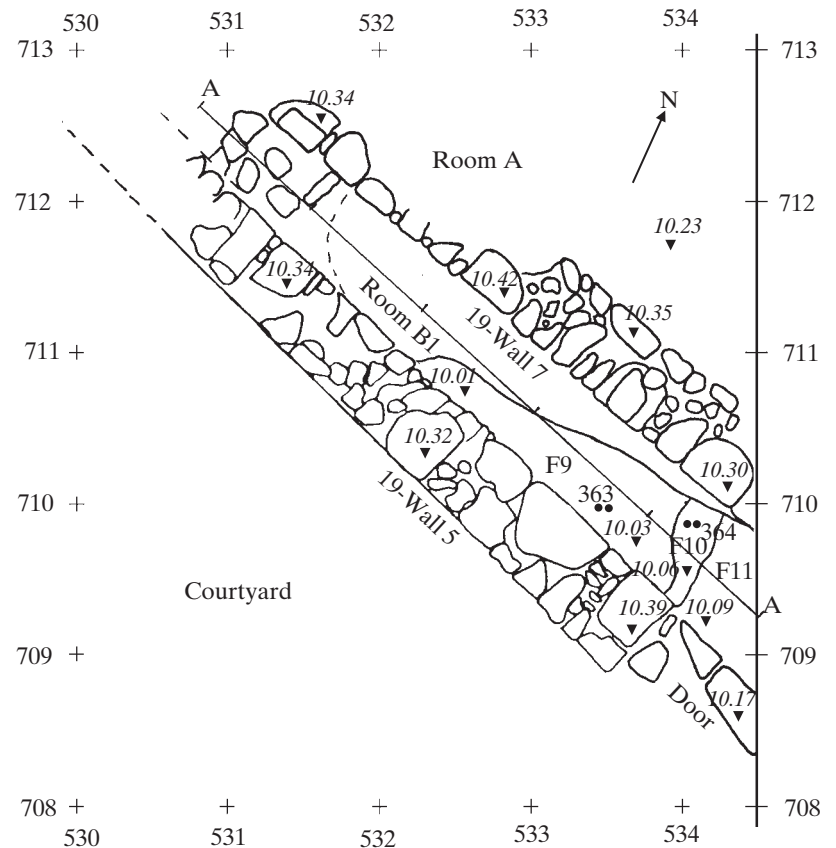
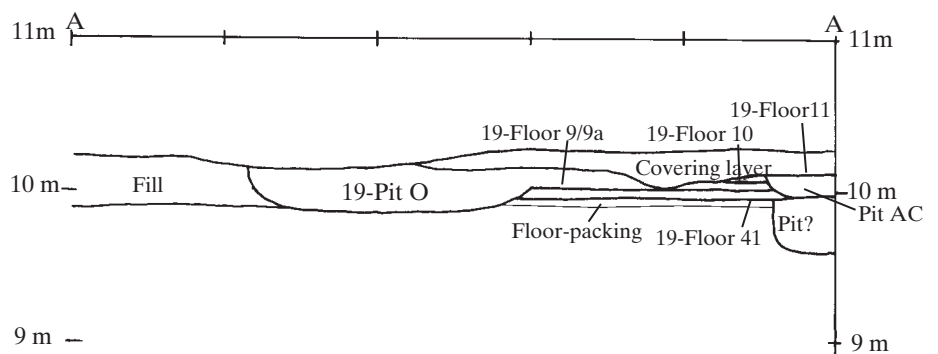

Fig. 60. Building 2, section A-A; cf. Fig. 59.



#### POTTERY

82-P 1359, *Pl. 174e:5*

**Stirrup jar**, miniature, lower body frg. Clay: LW. Part of a high, raised base. Ext. a body band. Th. 0.004-6. LM IIIA:2/B:1.

82-P 1360, *Pl. 174e:3*

**Kylix**, rim frg. Clay: LW. Everted rim, scar from a handle. Int. and ext. RB. Rim Ø est. 0.18. Th. 0.003-4. LM IIIB:1.

82-P 1361, *Pl. 174e:4*

**Amphoroid krater**, upper body frg. Clay: LW. Ext. neck band and an octopus. Th. 0.007-9. LM IIIB:1.

82-P 1362, *Pl. 174e:6*

**Bowl**, rim frg. Clay: LW. Slightly marked rim, flat on top. Int. RB. Ext. RB and Minoan flowers. Rim Ø est. 0.16. Th. 0.003-4. LM IIIB:1.

82-P 1363, *Pl. 174e:8*

**Closed vessel**, body frg. Clay: light reddish-brown. Cream slip and orange-brown paint. Ext. one thin and two broad body bands. Th. 0.006-13. LM IIIA:2/B:1.

82-P 1364, *Pl. 174e:7*

**Kylix**, stem/foot frg. Clay: brown with grey core. Low thick hollowed

stem. Ext. monochrome stem with a reserved band. Stem Ø 0.032. LM IIIB:1.

82-P 1434, *Pl. 174e:2*

**Bowl**, rim frg. Clay: light brown, hard, fine. Straight rim. Int. monochrome. Ext. RB, spirals and chevrons. Rim Ø est. 0.15. Th. 0.004-5. KNO. LM IIIB:1.

82-P 1435, *Pl. 174e:1*

**Footed cup**, two-handled, rim frg. Clay: light brown. Slightly marked rim, scar from a vertical, oval handle. Int. RB. Ext. RB and concentric semicircles. Rim Ø est. 0.12. Th. 0.003-4. LM IIIB:1.

82-P 1464, *Pl. 174e:9*

**Closed vessel**, body frg. Clay: light red. From upper part of vessel. Ext. a spiral. Th. 0.005-6. LM IIIA:2/B:1.

#### BONES

Bones from one adult *Equus asinus*.

### Floor deposit (Figs. 59-60, Pl. 59b)

Above the youngest floor (19-Floor 11) in the room a small deposit was found situated east of 534 with the bottom level at 10.09. The soil was, like the covering layer, dark red-brown and rather loose. Among the few sherds were noted LM IIIA and LM IIIB. 0.525 kg of pottery was collected: 9% decorated, 91% kept and 2.6% inventoried. No shapes to be counted.

#### POTTERY

82-P 0828, *Pl. 174d:6*

**Cup**, rim frg. Clay: reddish-brown. Yellow slip and black paint. Straight rim, beg. of a vertical, strap/oval handle. Int. and ext. RB. bands along edges of handle. Rim too straight to give a Ø. Handle 0.007 × 0.020. Th. 0.005. (May belong to 82-P 0579+, 19-Pit P, below p. 141). LM IIIB:1.

### In 19-Floor 11 (Figs. 59, 60, Pl. 59b, c)

The floor was found north of the doorway only and was 0.04 thick, excavated at levels from 10.09 to 10.05. It was brown-reddish, soft and sandy without much pottery nor stones. Immediately below the floor a shallow pit was found, 19-Pit AC at levels 10.05 to 9.94. Soil description and bag with pottery temporarily misplaced.

#### SHELLS

1 *Spondylus* – upper, medium, burnt grey.

### In 19-Floor 10 (Figs. 59, 60, Pl. 59b)

This floor fragment was only discovered in 0.20 to 0.30 width across the room around 534. It was red, very hard with pieces of charcoal and pumice stones. Excavated at levels from 10.05 to 10.03. Two sherds LM IIIA and B? were found and inventoried. 0.005 kg of pottery was collected: 100% decorated, 100% kept and 100% inventoried. No shapes to be counted.

#### POTTERY

84-P 1700, outside j.

84-P 1701, *Pl. 174f:8*

**Cup**, miniature, body frg. Clay: LW. Ext. wavy band and two thin body bands. Th. 0.004. LM IIIB:1.

#### Outside joins

84-P 1700 to 84-P 1925, LM IIIA:2, Building 2, Room B1, 19-Floor 9/9a, p. 235.

### Fill in western part (Figs. 59, 60, Pl. 59d)

In the western part of the room (west of 19-Pit O) no floors were discovered, but a fill which could be followed from 10.32 to 9.91. The soil in this fill was hard, red to brown, sandy with small bits of charcoal and many medium-sized stones. The latest pottery in this fill is LM IIIB:1, while LM IIIA and a few earlier pieces were also noted. 3.950 kg of pottery were collected: 8% decorated, 92% kept and 3.2% inventoried. Shapes were not counted in 1982 and no shapes could be counted in 1984.

#### POTTERY

82-P 0755, *Pl. 174f:7*

**Closed vessel**, body frg. Clay: dark yellowish-brown. Ext. two narrow body bands between two broader and a curved band above. Th. 0.009-12. LM IIIA:2/B:1.

82-P 0756, *Pl. 174f:4*

**Kylix**, body frg. Clay: red. Int. irregular drops of paint. Ext. ending vertical bands (spray/flower). Th. 0.005-6. LM IIIB:1.

82-P 0757, *Pl. 174f:10*

**Amphoroid krater**, rim/neck frg. Clay: yellow with light grey core (LW). Everted rim, flat on top. Int. RB. Top of rim barred. Ext. broad RB. Rim Ø est. 0.25. Th. 0.005. LM IIIB:1.

82-P 0758, *Pl. 174f:6*

**Cup**, rim frg. Clay: LW. Slightly marked rim. Int. RB. Ext. RB and alternating arcs. Th. 0.004-5. LM IIIB:1.

82-P 0759, *Pl. 174f:9*

**Kylix**, body frg. Clay: light red with yellow core. Ext. three accidental drops. Th. 0.003-4. LM IIIB:1.

82-P 1585, *Pl. 174f:5*

**Closed vessel**, body frg. Clay: LW. Ext. a vertical band. Th. 0.004-5. LM IIIA:2/B:1.

84-P 1420, *Pls. 91, 174f:1*

**Cup**, rim/body frg. Clay: brown. Slightly marked rim. Int. RB. Ext. RB, sea-anemones and two body bands pres. Rim Ø est. 0.14. Th. 0.003-4. LM IIIB:1.

84-P 1421, *Pl. 174f:2*

**Kylix**, body frg. Clay: brown. Ext. a whorl shell. Th. 0.003-4. LM IIIB:1.

84-P 1422, *Pl. 174f:3*

**Closed vessel**, body frg. Clay: light greyish-brown. Ext. running spiral and a body band pres. Th. 0.003. LM IIIA:2/B:1.

*Comments:* The large amount of stones found in the western part of the room may be taken as an indication that this part was filled in and went out of use during the period. See further comments in connection with doorway and Courtyard below.

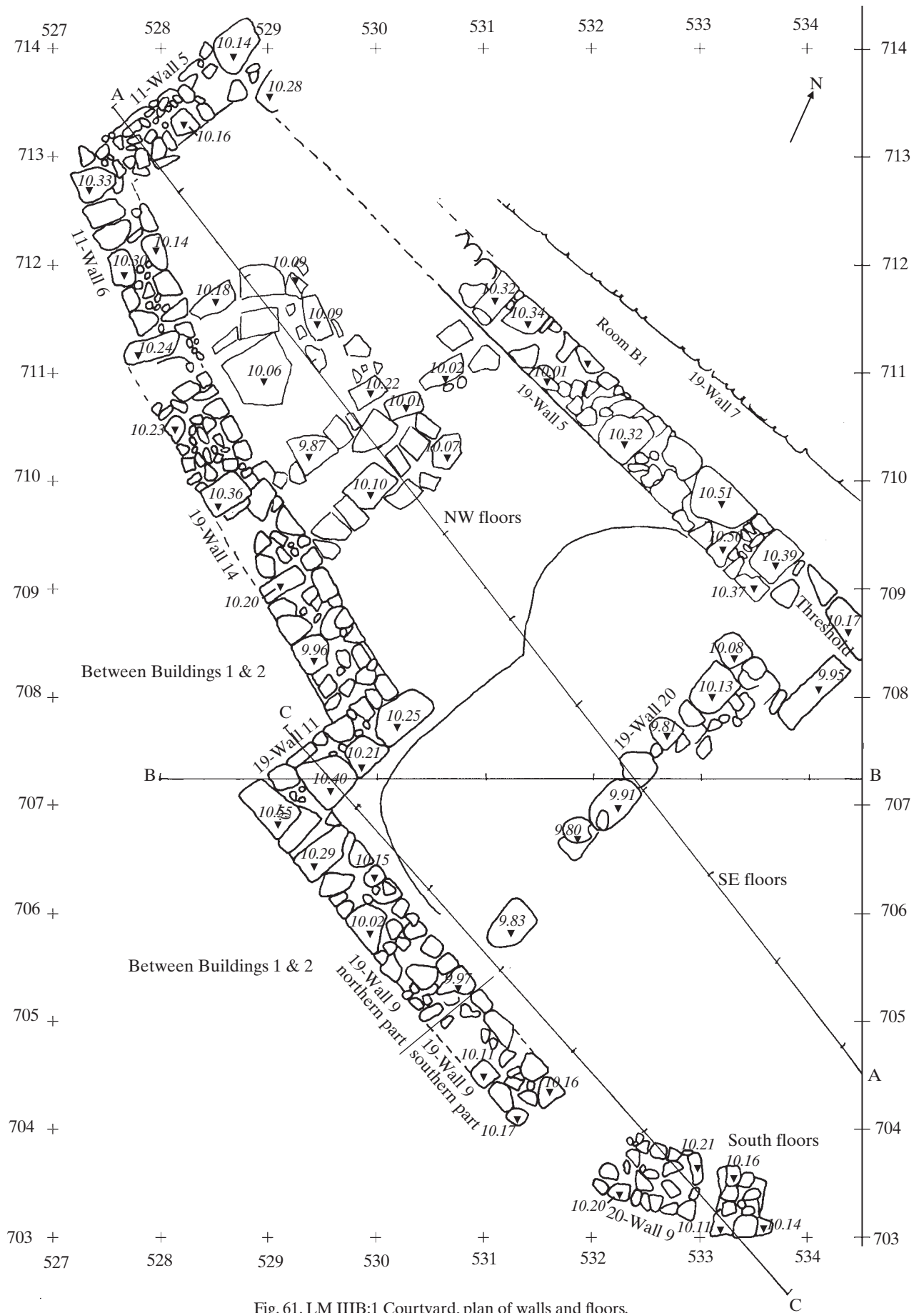

Fig. 61. LM IIIB:1 Courtyard, plan of walls and floors.



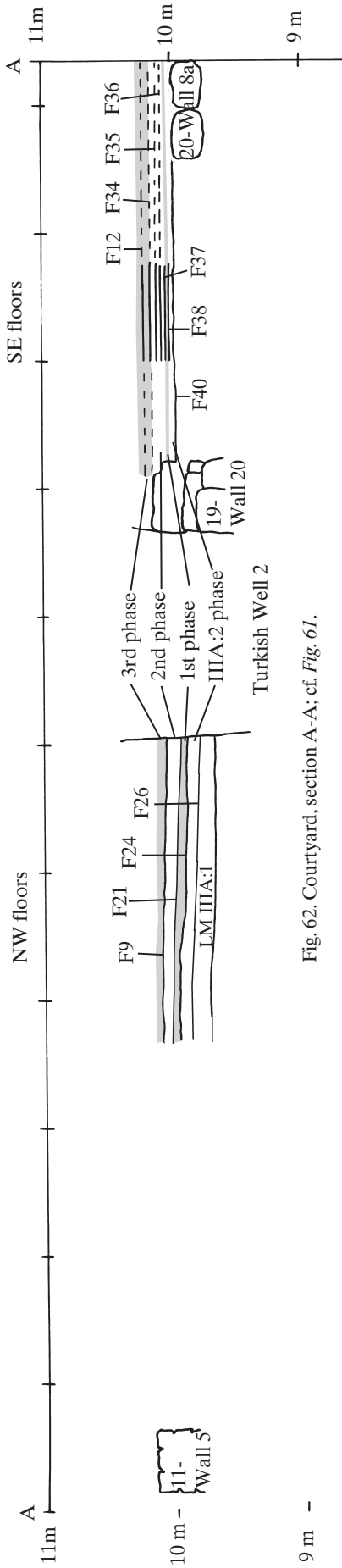

Fig. 62. Courtyard, section A-A; cf. Fig. 61.

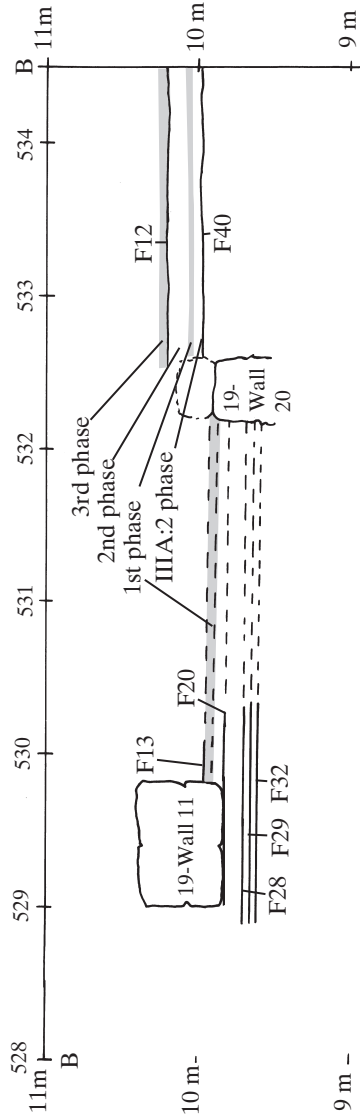

Fig. 63a. Courtyard, section B-B; cf. Fig. 61.

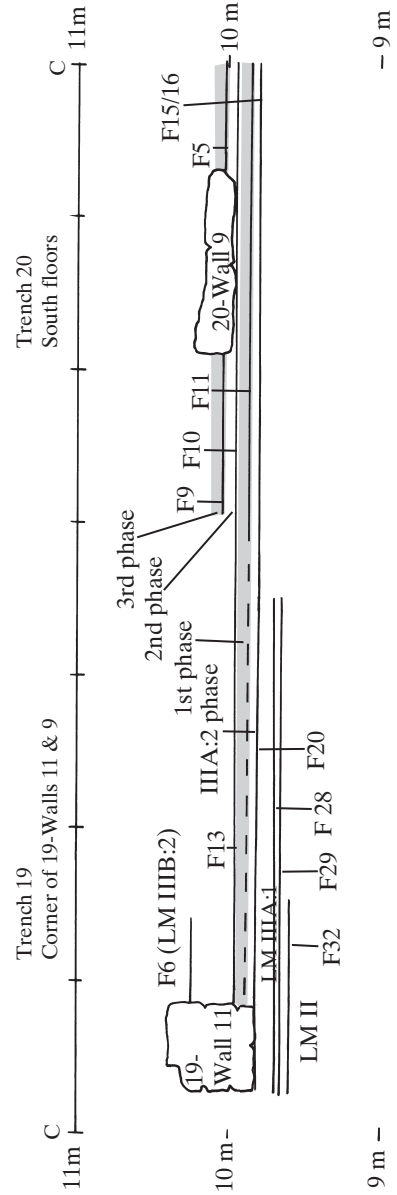

Fig. 63b. Courtyard, section C-C; cf. Fig. 61.